

# POLICE DETENTION CENTERS REHABILITATION PROJECT

Book of Detail - Police Requirement

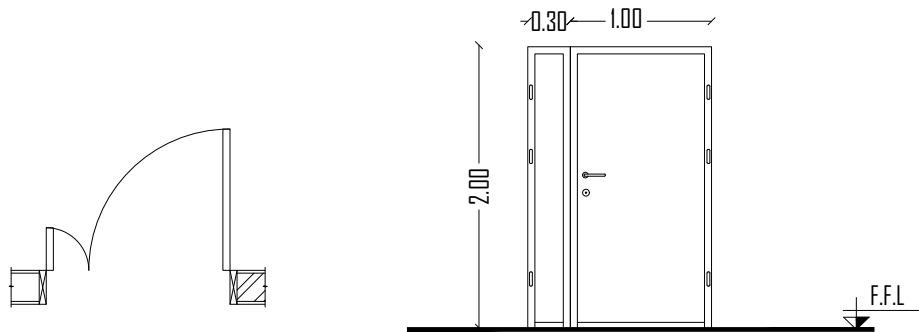

		D0
STRUCTURAL OPENING		130x 200
DESCRIPTION		② ⑤ ⑥ ⑦
FINISH	FRAME	⑩
	LEAF	⑦
HARD WARE	HANGS	⑦
	LOCK	⑦ ⑰
	HANDLE	HEAVY DUTY

## D0/Main External Door

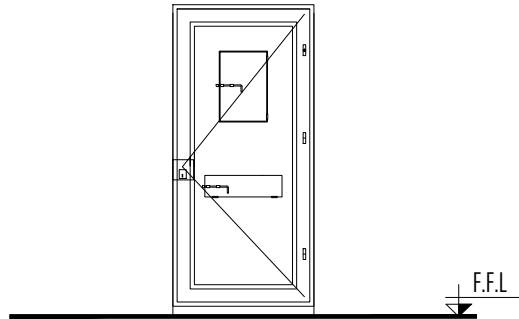

		D1
STRUCTURAL OPENING		100x 200
DESCRIPTION		② ④ ⑥
FINISH	FRAME	⑩
	LEAF	⑪
HARD WARE	HANGS	⑬
	LOCK	⑰ ⑱
	HANDLE	HEAVY DUTY

## D1/Detention Doors

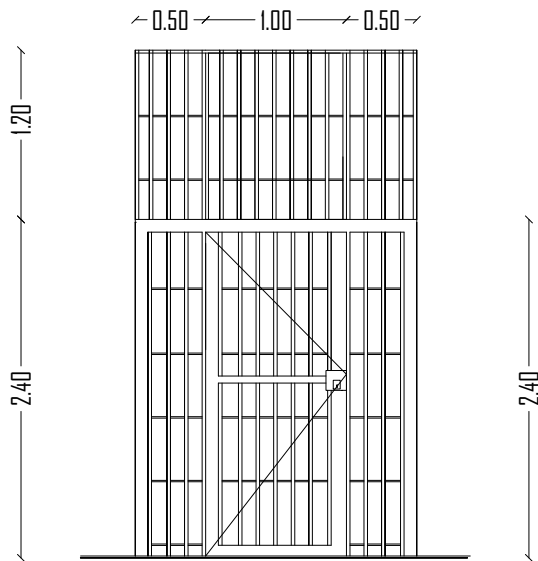

		D6
STRUCTURAL OPENING		200x 360
DESCRIPTION		② ⑥
FINISH	FRAME	⑩
	LEAF	⑪
HARD WARE	HANGS	⑬
	LOCK	⑰ ⑱
	HANDLE	HEAVY DUTY

## D2/Corridor Door

### ABBREVIATIONS

- |   |   |   |  |
|---|---|---|--|
| ① | WOODEN DOOR.  | ⑩ | 3 MM GALVANIZED STEEL FRAME .              |
| ② | STEEL DOOR.   | ⑪ | OIL COLOR PAINT .                          |
| ③ | TEMPERED GLASS DOOR (10MM)                              | ⑫ | VENEER 5mm THICK.                          |
| ④ | SINGLE LEAF DOOR.                                       | ⑬ | WATER PROOF FLUSH PLATE.                   |
| ⑤ | DOUBLE LEAF DOOR.                                       | ⑭ | LOUVER OPENING.                            |
| ⑥ | ONE DIRECTION OPENING.                                  | ⑮ | KICK OUT HANDLE.                           |
| ⑦ | READY MADE DOOR (MULTI LOCK) WITH ORIGINAL ACCESSORIES. | ⑯ | 3 HANGS.                                   |
| ⑧ | SLIDING DOOR.   | ⑰ | MASTER KEY.                                |
| ⑨ | SOLID WOOD (SWEDEN)                                     | ⑱ | WALLY CYLINDER OR EQUIVALENT.              |
|   |   | ⑲ | AUTOMATIC OPENING DOOR (PHOTOCELL)         |
|   |   | ⑳ | DORMA OR EQUIVALENT MOTOR AND ACCESSORIES. |

### LEGEND

1- REINFORCED CONCRETE



2- CONCRETE BLOCK WALL



### NOTES

Rev.: Date: Description: Approved:

All information in this document is the property of PALESTINIAN CIVIL POLICE and cannot be copied anywhere but in this project without prior written consent of PALESTINIAN CIVIL POLICE.

Partners:

The Independent Commission For Human Rights (ICHR)

PALESTINIAN CIVIL POLICE

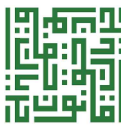

Funded by:



Kingdom of Norway

Design & Implementation:



QURIE  
ARCHITECTURE

Project Name:

Detention Centers Rehabilitation Project in the West Bank (Norwegian Grant)

Title:

Book of Detail  
Police Requirement

Drawings Title:

Door Details (1)

Project No.:	Phase:	Discipline:	Date:	Drawing No.:
00000	01	Var	11.2021	1
Drawn:	Checked:	Approved:	Size:	Scale:
			A3	-

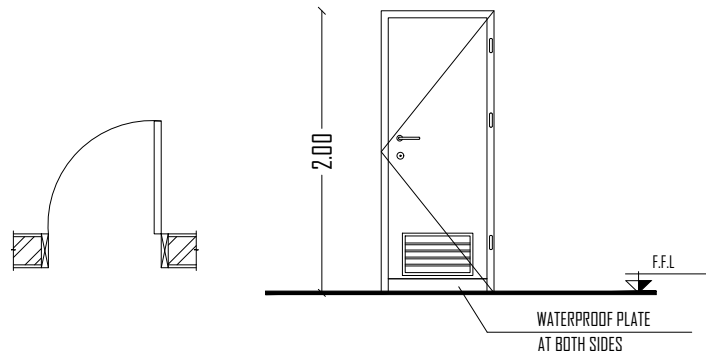

		D3
STRUCTURAL OPENING		80x 200
DESCRIPTION		① ④ ⑥ ⑭
FINISH	FRAME	⑨
	LEAF	⑫ ⑬
HARD WARE	HANGS	⑩
	LOCK	⑰ ⑱
	HANDLE	HEAVY DUTY

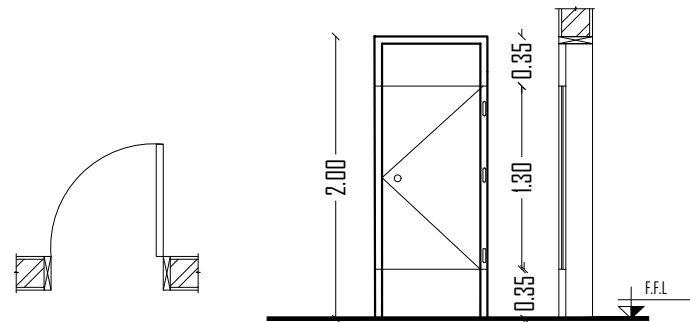

		D4
STRUCTURAL OPENING		80x 200
DESCRIPTION		① ④ ⑥
FINISH	FRAME	⑨
	LEAF	⑫
HARD WARE	HANGS	⑩
	LOCK	⑰ ⑱
	HANDLE	HEAVY DUTY

## LEGEND

1- REINFORCED CONCRETE



2- CONCRETE BLOCK WALL



## NOTES

Rev.: Date: Description: Approved:

All information in this document is the property of PALESTINIAN CIVIL POLICE and cannot be copied anywhere but in this project without prior written consent of PALESTINIAN CIVIL POLICE.

Partners:

The Independent Commission  
For Human Rights (ICHR)

PALESTINIAN CIVIL POLICE

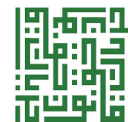

Funded by:



Kingdom of Norway

Design & Implementation:



QURIE  
ARCHITECTURE

Project Name:

Detention Centers Rehabilitation  
Project in the West Bank  
(Norwegian Grant)

Title:

Book of Detail  
Police Requirement

Drawings Title:

Door Details (2)

Project No.:	Phase:	Discipline:	Date:	Drawing No.:
00000	01	Var	11.2021	2
Drawn:	Checked:	Approved:	Size:	Scale:
			A3	-

# D3/WC's Doors

# D4/Shower Doors

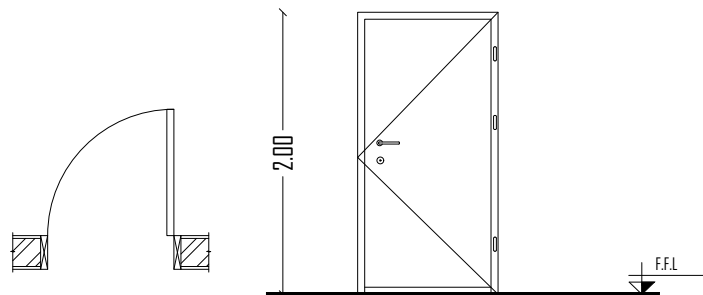

		D5
STRUCTURAL OPENING		100x 200
DESCRIPTION		① ④ ⑥
FINISH	FRAME	⑨
	LEAF	⑪
HARD WARE	HANGS	⑩
	LOCK	⑰ ⑱
	HANDLE	HEAVY DUTY

## ABBREVIATIONS

- |   |  |   |  |
|---|--|---|--|
| ① | WOODEN DOOR.   | ⑩ | 3 MM GALVANIZED STEEL FRAME .              |
| ② | STEEL DOOR.  | ⑪ | OIL COLOR PAINT .                          |
| ③ | TEMPERED GLASS DOOR (10MM)                                 | ⑫ | VENEER 5mm THICK.                          |
| ④ | SINGLE LEAF DOOR.  | ⑬ | WATER PROOF FLUSH PLATE.                   |
| ⑤ | DOUBLE LEAF DOOR.  | ⑭ | LOUVER OPENING.                            |
| ⑥ | ONE DIRECTION OPENING.                                     | ⑮ | KICK OUT HANDLE.                           |
| ⑦ | READY MADE DOOR (MULTI LOCK)<br>WITH ORIGINAL ACCESSORIES. | ⑯ | 3 HANGS.                                   |
| ⑧ | SLIDING DOOR.  | ⑰ | MASTER KEY.                                |
| ⑨ | SOLID WOOD (SWEDEN)  | ⑱ | WALLY CYLINDER OR EQUIVALENT.              |
|   |  | ⑲ | AUTOMATIC OPENING DOOR (PHOTOCELL)         |
|   |  | ⑳ | DORMA OR EQUIVALENT MOTOR AND ACCESSORIES. |

# D5/Offices Doors



Section 2-2  
TYPICAL VERTICAL SECTION THROUGH METAL DOOR  
Not to Scale

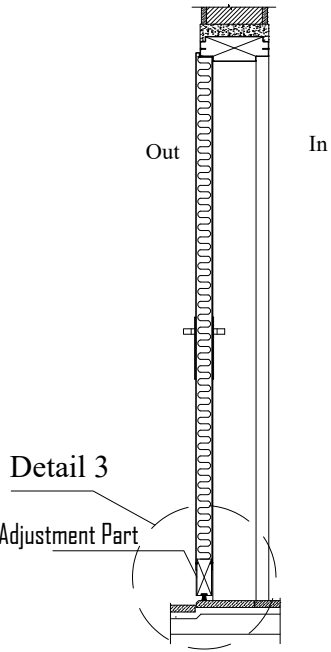

Details  
Not to Scale

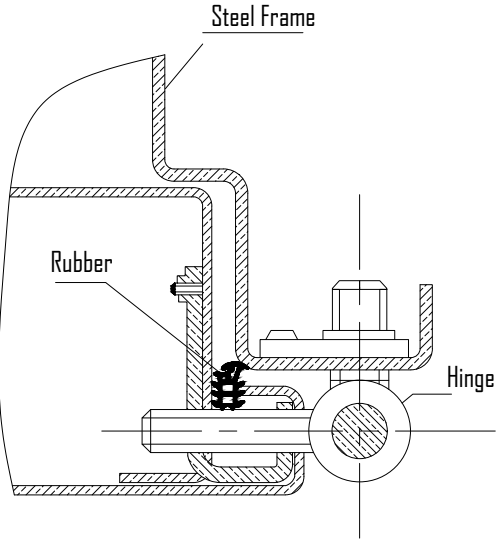

HINGE DETAIL  
Detail 2

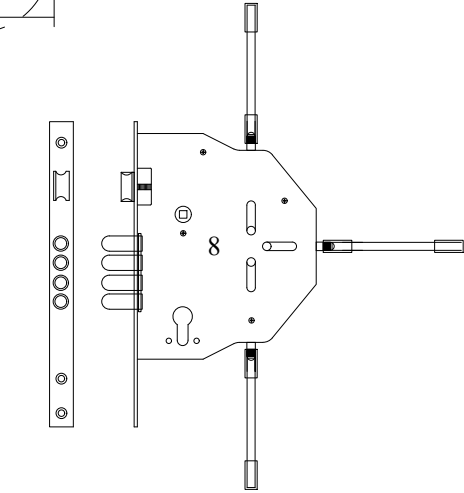

CYLINDER LOCK SN 2000  
Detail 1

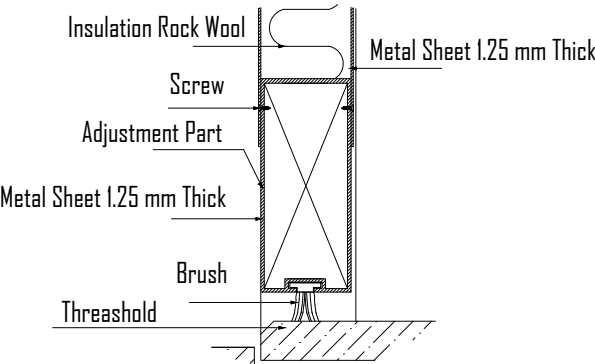

Detail 3

TYPICAL DOOR ELEVATION  
Scale 1:25

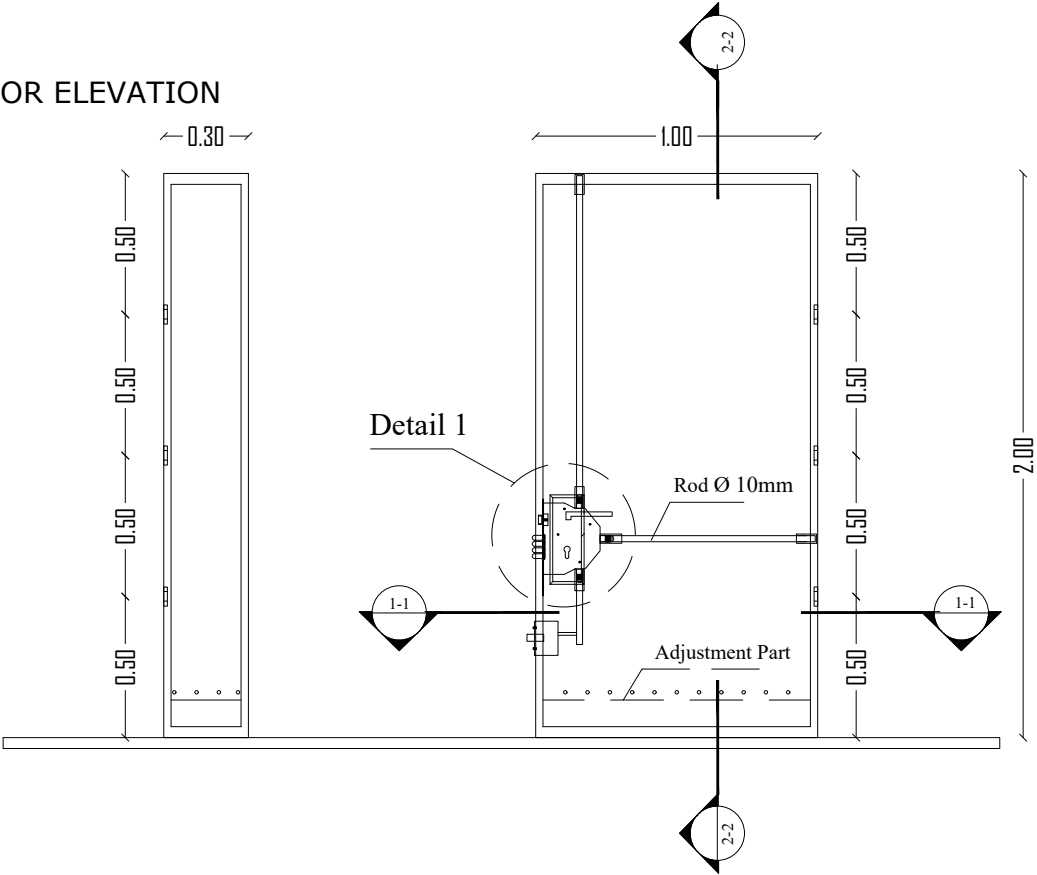

Section 1-1  
TYPICAL HORIZONTAL SECTION THROUGH METAL DOOR  
Not to Scale

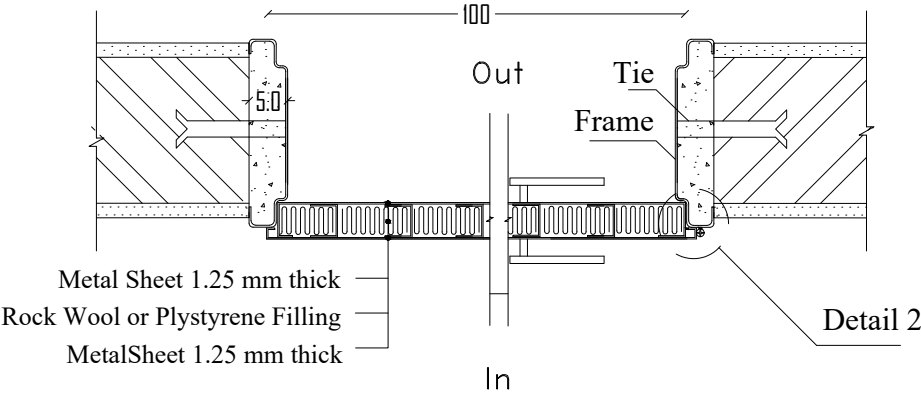

LEGEND

1- REINFORCED CONCRETE	
2- CONCRETE BLOCK WALL	

NOTES

Rev.:	Date:	Description:	Approved:
-------	-------	--------------	-----------

All information in this document is the property of PALESTINIAN CIVIL POLICE and cannot be copied anywhere but in this project without prior written consent of PALESTINIAN CIVIL POLICE.

Partners:

The Independent Commission For Human Rights (ICHR)	PALESTINIAN CIVIL POLICE

Funded by:

	Kingdom of Norway
--	-------------------

Design & Implementation:

	QURIE ARCHITECTURE
--	-----------------------

Project Name:

Detention Centers Rehabilitation Project in the West Bank (Norwegian Grant)

Title:

Book of Detail  
Police Requirement

Drawings Title:

Multi-lock Door Details

Project No.:	Phase:	Discipline:	Date:	Drawing No.:
00000	01	Var	11.2021	4
Drawn:	Checked:	Approved:	Size:	Scale:
			A3	-

DD/D7 Main External Door

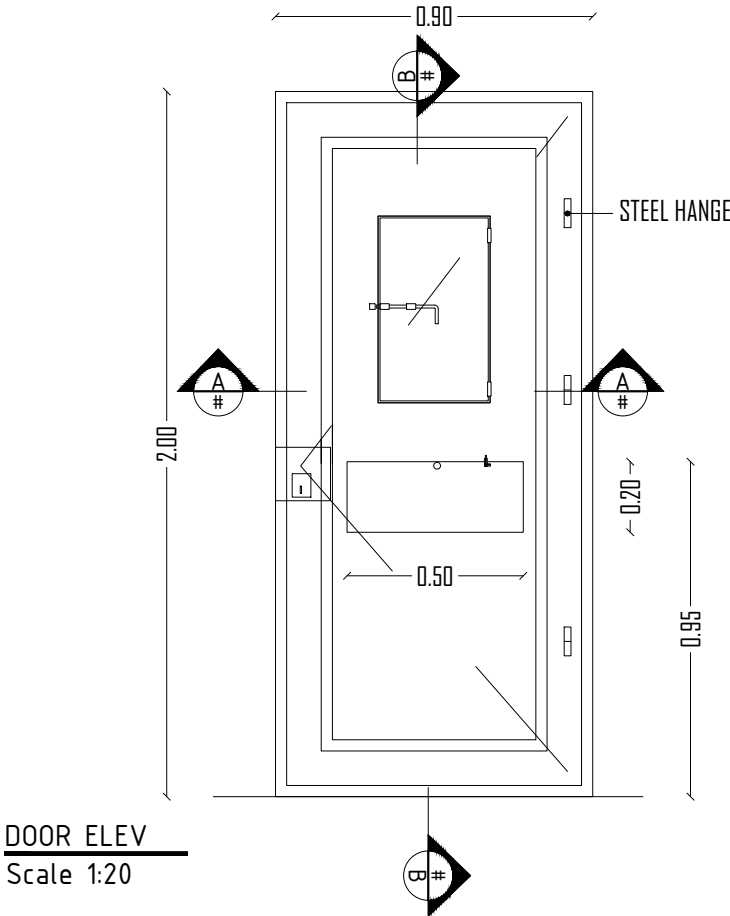

DOOR ELEV  
Scale 1:20

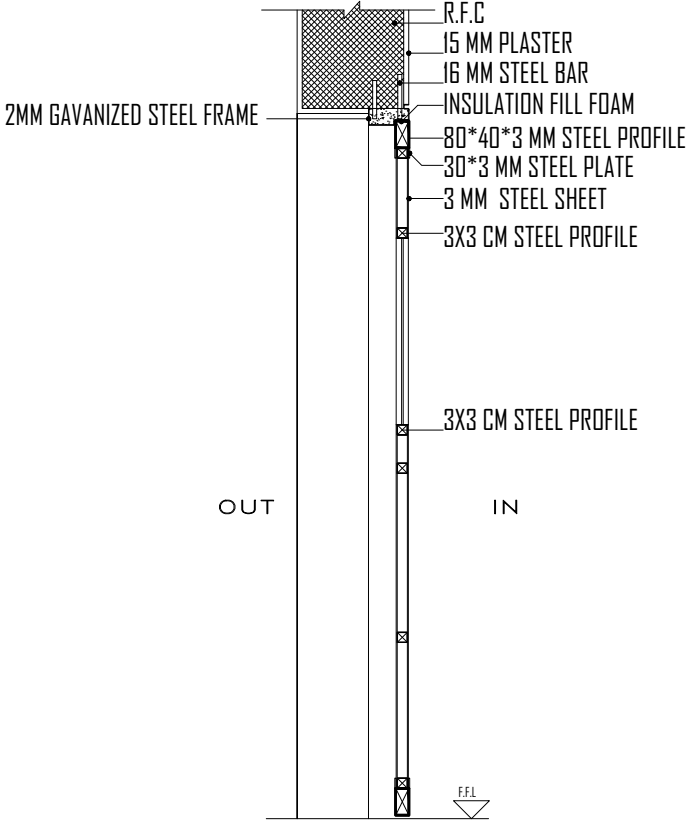

DOOR SEC B:B  
Scale 1:20

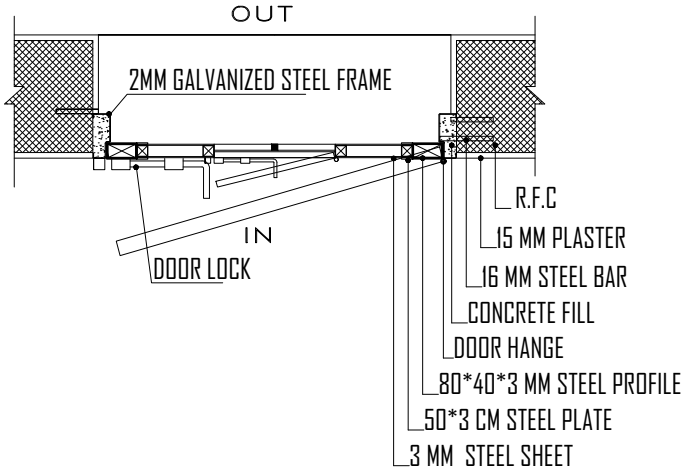

DOOR SEC A:A  
Scale 1:20

# D1/Detention Doors

## LEGEND

1- REINFORCED CONCRETE	
2- CONCRETE BLOCK WALL	

## NOTES

Rev.:	Date:	Description:	Approved:
-------	-------	--------------	-----------

All information in this document is the property of PALESTINIAN CIVIL POLICE and cannot be copied anywhere but in this project without prior written consent of PALESTINIAN CIVIL POLICE.

Partners:

The Independent Commission For Human Rights (ICHR)	PALESTINIAN CIVIL POLICE

Funded by:

	Kingdom of Norway
--	-------------------

Design & Implementation:

	QURIE ARCHITECTURE
--	-----------------------

Project Name:

Detention Centers Rehabilitation  
Project in the West Bank  
(Norwegian Grant)

Title:

Book of Detail  
Police Requirement

Drawings Title:

Detention Room Steel Door  
Details

Project No.:	Phase:	Discipline:	Date:	Drawing No.:
00000	01	Var	11.2021	5
Drawn:	Checked:	Approved:	Size:	Scale:
			A3	-

# D2/D6 Corridor Door

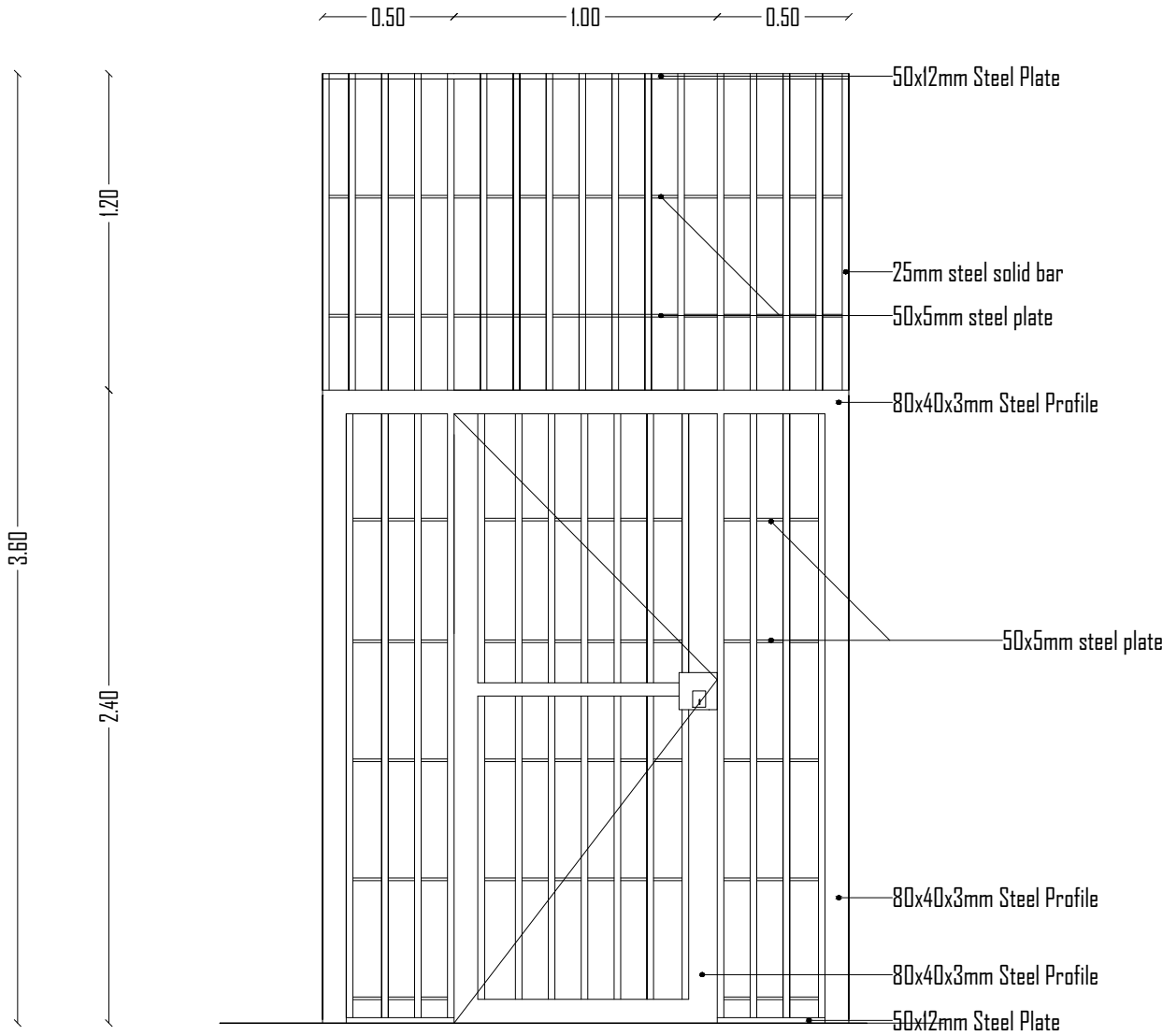

## LEGEND

1- REINFORCED CONCRETE



2- CONCRETE BLOCK WALL



## NOTES



Rev.: Date: Description: Approved:

All information in this document is the property of PALESTINIAN CIVIL POLICE and cannot be copied anywhere but in this project without prior written consent of PALESTINIAN CIVIL POLICE.

Partners:

The Independent Commission  
For Human Rights (ICHR)

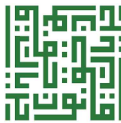
PALESTINIAN CIVIL POLICE



Funded by:



Kingdom of Norway

Design & Implementation:



QURIE  
ARCHITECTURE

Project Name:

Detention Centers Rehabilitation  
Project in the West Bank  
(Norwegian Grant)

Title:

Book of Detail  
Police Requirement

Drawings Title:

Corridor Steel Door Details

Project No.:	Phase:	Discipline:	Date:	Drawing No.:
00000	01	Var	11.2021	6
Drawn:	Checked:	Approved:	Size:	Scale:
			A3	-

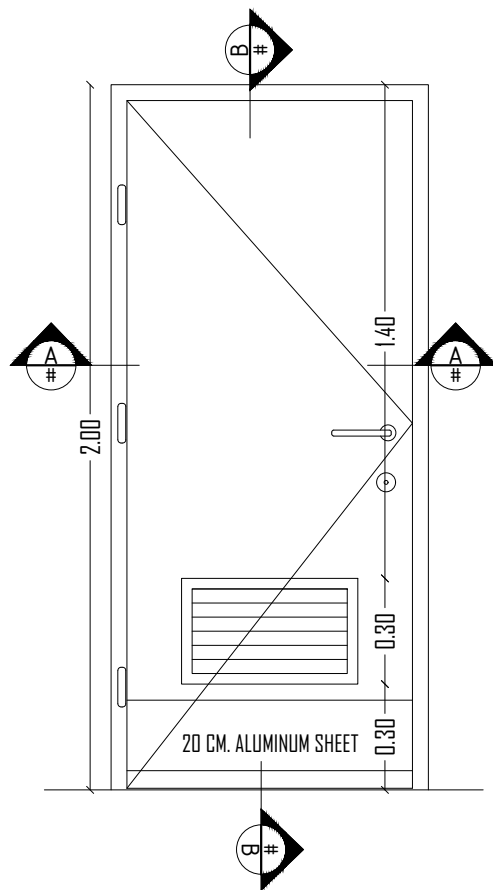

DOOR ELEV  
Scale 1:20

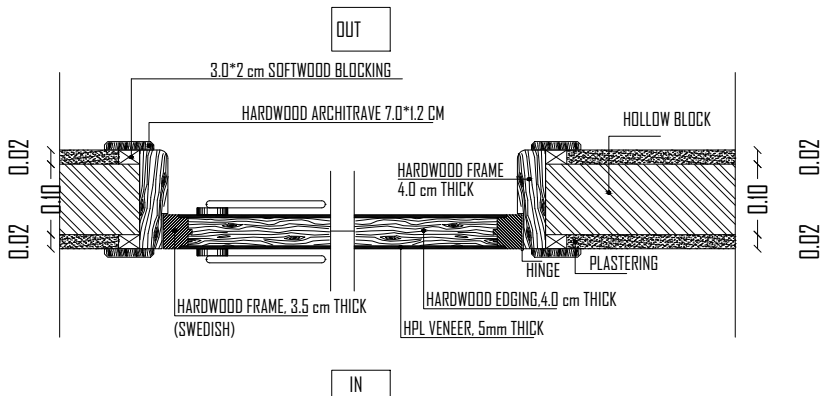

DOOR SEC A:A  
Scale 1:10

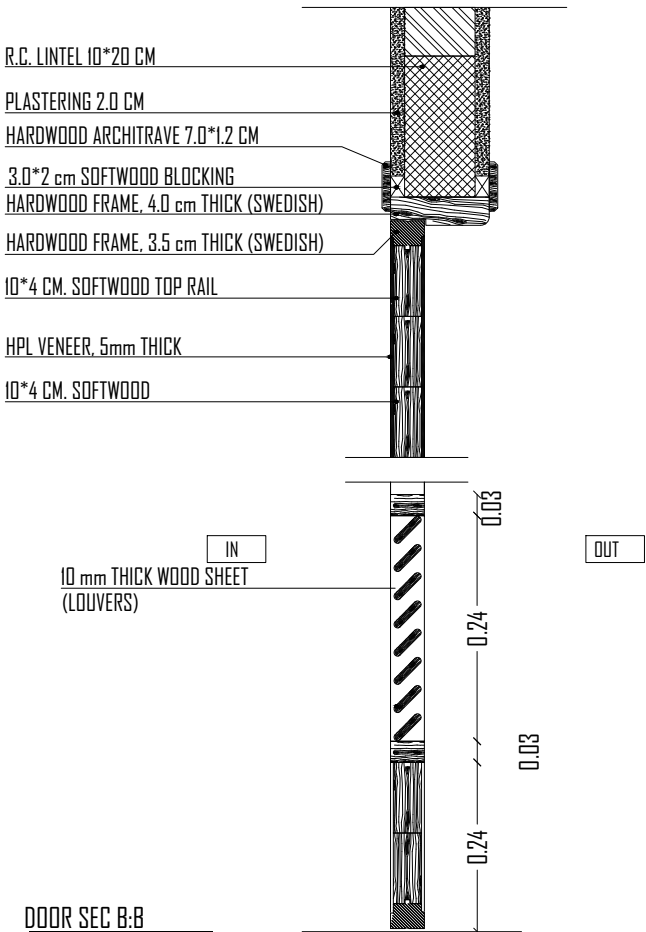

DOOR SEC B:B  
Scale 1:10

LEGEND

- 1- REINFORCED CONCRETE  
2- CONCRETE BLOCK WALL

NOTES

Rev.: Date: Description: Approved:

All information in this document is the property of PALESTINIAN CIVIL POLICE and cannot be copied anywhere but in this project without prior written consent of PALESTINIAN CIVIL POLICE.

Partners:

The Independent Commission For Human Rights (ICHR)

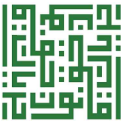

PALESTINIAN CIVIL POLICE



Funded by:



Kingdom of Norway

Design & Implementation:



QURIE  
ARCHITECTURE

Project Name:

Detention Centers Rehabilitation  
Project in the West Bank  
(Norwegian Grant)

Title:

Book of Detail  
Police Requirement

Drawings Title:

WC's Door Details

Project No.:	Phase:	Discipline:	Date:	Drawing No.:
00000	01	Var	11.2021	7
Drawn:	Checked:	Approved:	Size:	Scale:
			A3	-



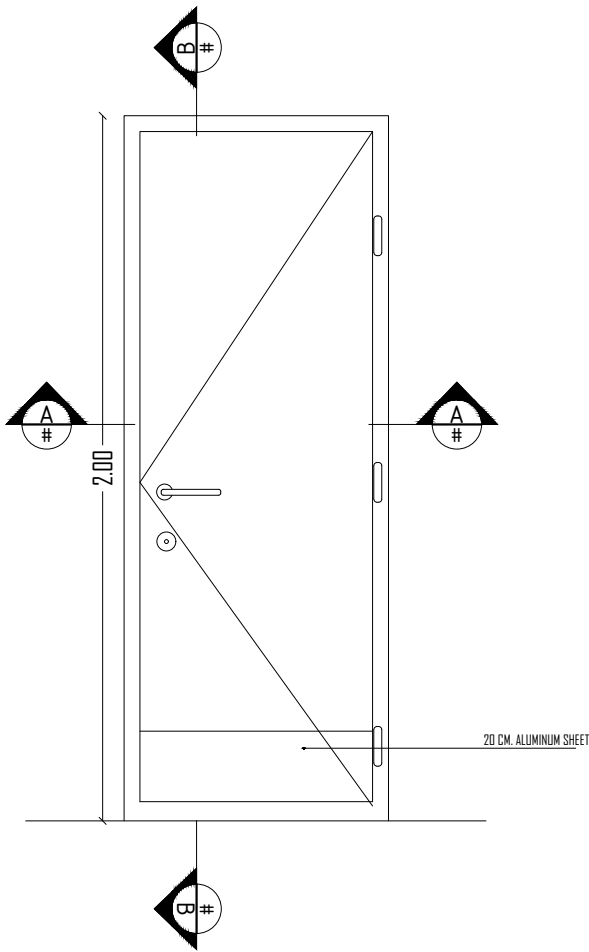

DOOR ELEV  
Scale 1:20

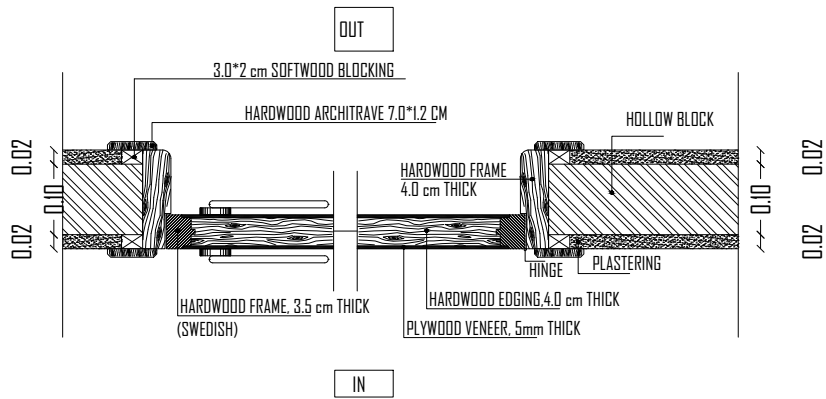

DOOR SEC A:A  
Scale 1:10

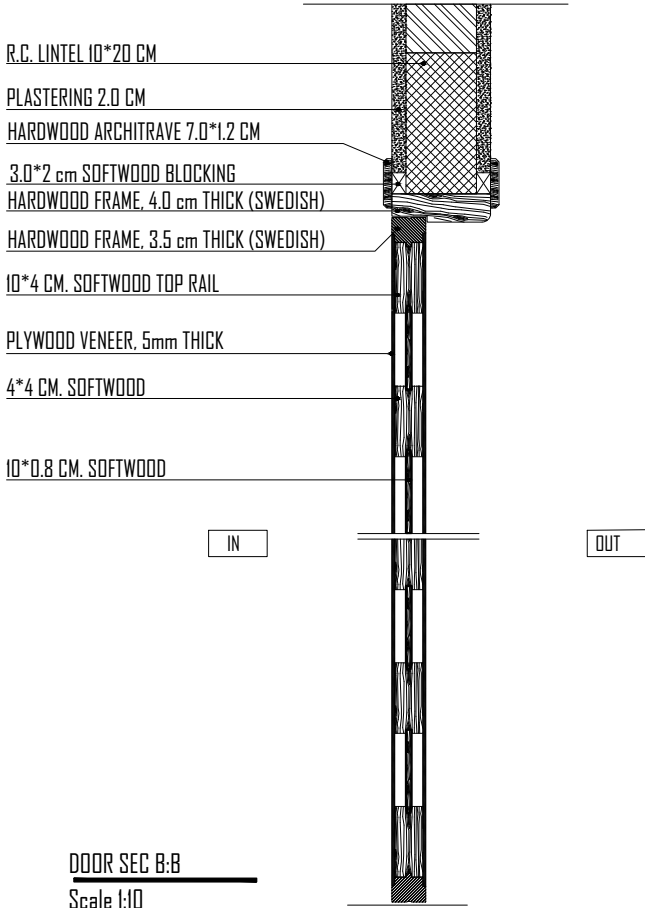

DOOR SEC B:B  
Scale 1:10

LEGEND

1- REINFORCED CONCRETE



2- CONCRETE BLOCK WALL



NOTES



Rev.:	Date:	Description:	Approved:
-------	-------	--------------	-----------

All information in this document is the property of PALESTINIAN CIVIL POLICE and cannot be copied anywhere but in this project without prior written consent of PALESTINIAN CIVIL POLICE.

Partners:

The Independent Commission  
For Human Rights (ICHR)

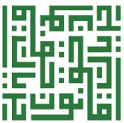
PALESTINIAN CIVIL POLICE



Funded by:



Kingdom of Norway

Design & Implementation:



QURIE  
ARCHITECTURE

Project Name:

Detention Centers Rehabilitation  
Project in the West Bank  
(Norwegian Grant)

Title:

Book of Detail  
Police Requirement

Drawings Title:

Office Door Details

Project No.:	Phase:	Discipline:	Date:	Drawing No.:
00000	01	Var	11.2021	8
Drawn:	Checked:	Approved:	Size:	Scale:
			A3	-

D5/Offices Doors

# Cell Windows Details

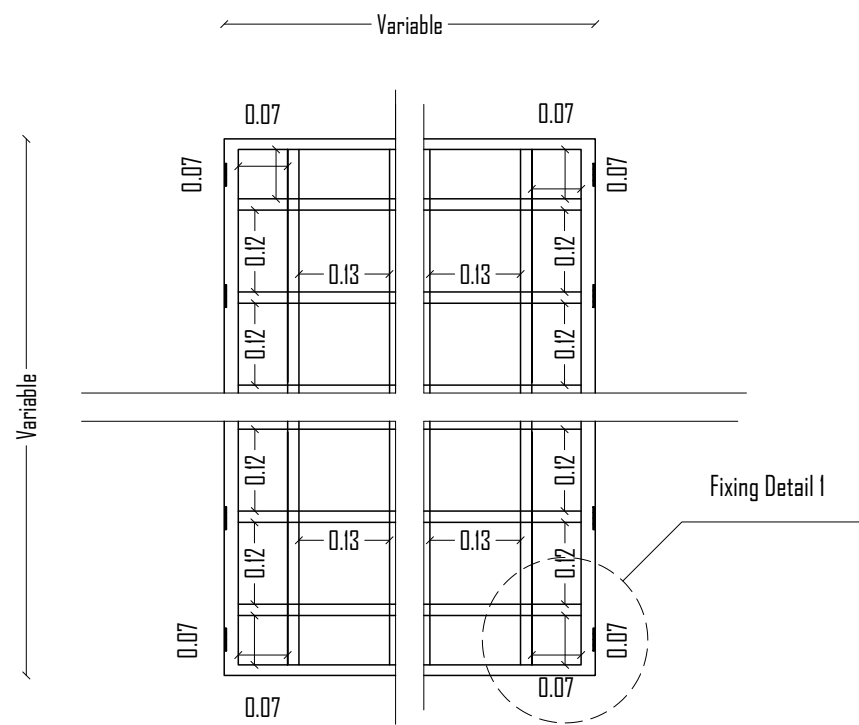

Steel Protection

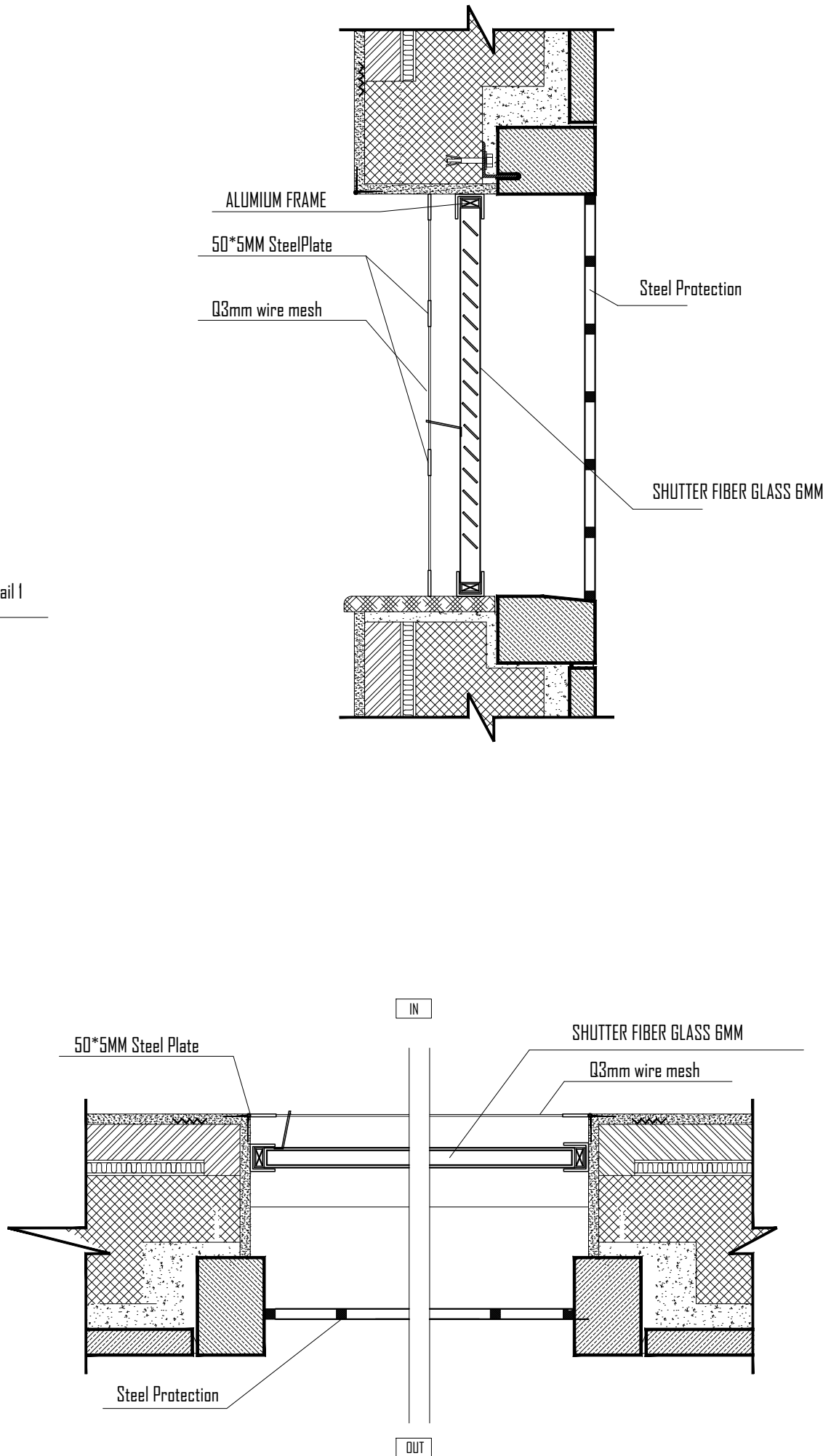

## LEGEND

1- REINFORCED CONCRETE



2- CONCRETE BLOCK WALL



## NOTES

Rev.: Date: Description: Approved:

All information in this document is the property of PALESTINIAN CIVIL POLICE and cannot be copied anywhere but in this project without prior written consent of PALESTINIAN CIVIL POLICE.

Partners:

The Independent Commission For Human Rights (ICHR)

PALESTINIAN CIVIL POLICE



Funded by:



Kingdom of Norway

Design & Implementation:



QURIE  
ARCHITECTURE

Project Name:

Detention Centers Rehabilitation Project in the West Bank (Norwegian Grant)

Title:

Book of Detail  
Police Requirement

Drawings Title:

Cell Windows Details

Project No.:	Phase:	Discipline:	Date:	Drawing No.:
00000	01	Var	11.2021	9
Drawn:	Checked:	Approved:	Size:	Scale:
			A3	-

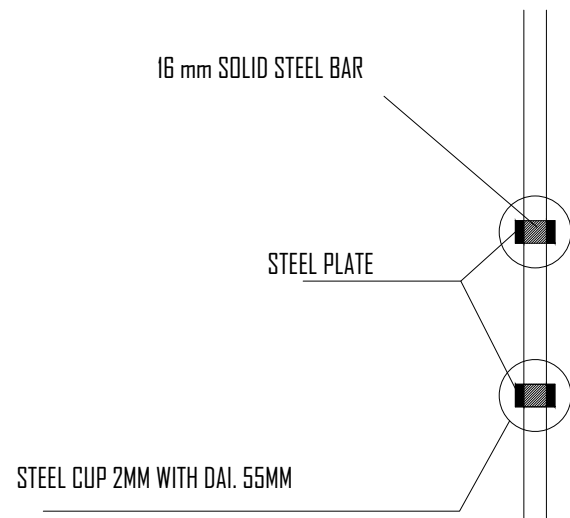

Steel Protection Elevation

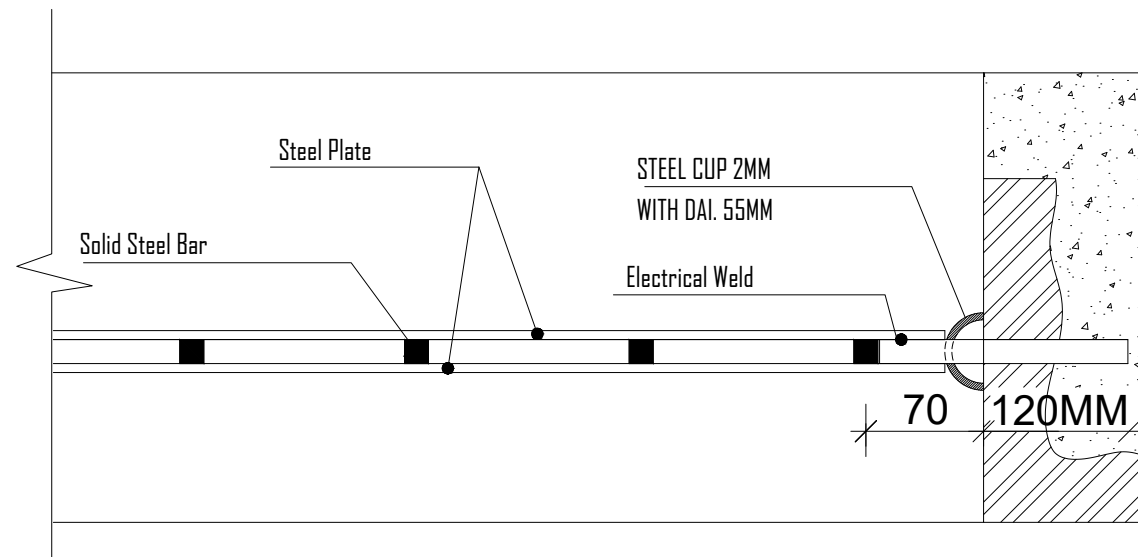

Steel Protection Plan

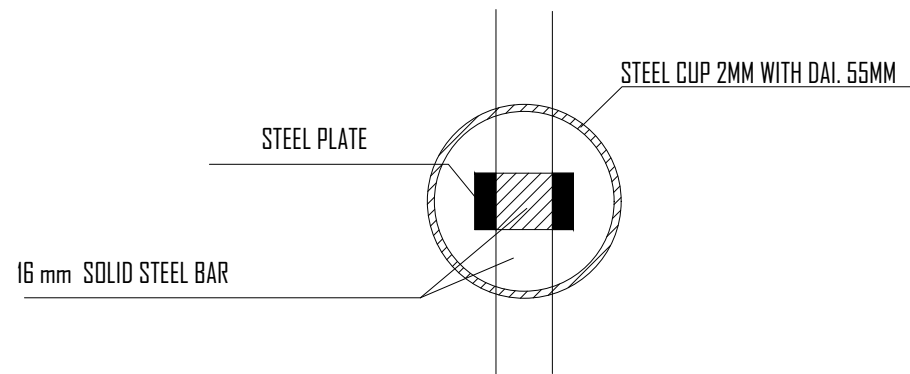

Steel Protection Detail

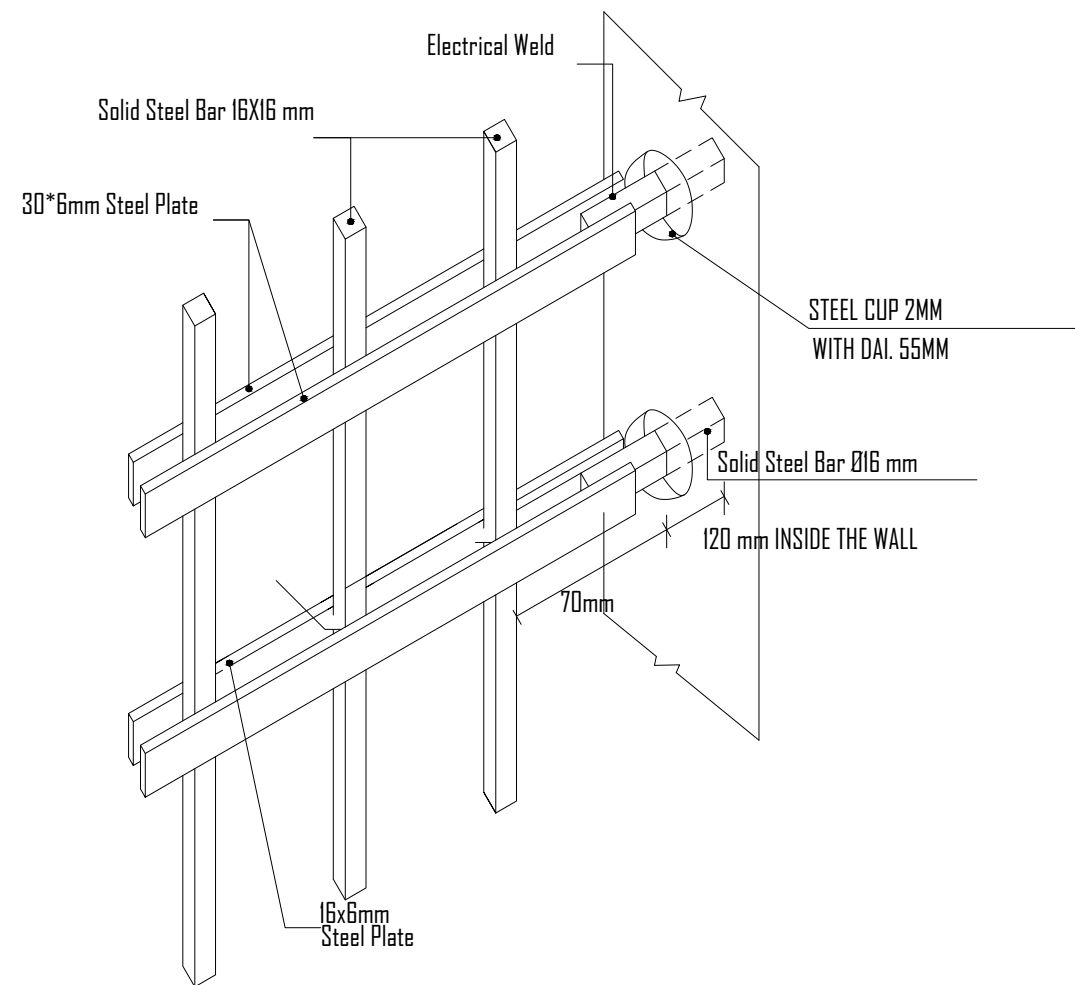

(Fixing Detail 1) For Steel Protection

LEGEND

1- REINFORCED CONCRETE

2- CONCRETE BLOCK WALL

NOTES

Rev.:	Date:	Description:	Approved:		
All information in this document is the property of PALESTINIAN CIVIL POLICE and cannot be copied anywhere but in this project without prior written consent of PALESTINIAN CIVIL POLICE.					
Partners:					
The Independent Commission For Human Rights (ICHR)		PALESTINIAN CIVIL POLICE			
Funded by:					
		Kingdom of Norway			
Design & Implementation:					
		QURIE ARCHITECTURE			
Project Name:					
Detention Centers Rehabilitation Project in the West Bank (Norwegian Grant)					
Title:					
Book of Detail Police Requirement					
Drawings Title:					
Cell Windows Details (2) Steel Protection Details					
Project No.:	Phase:	Discipline:	Date:	Drawing No.:	
00000	01	Var	11.2021	10	
Drawn:	Checked:	Approved:	Size:	Scale:	Rev.:
			A3	-	

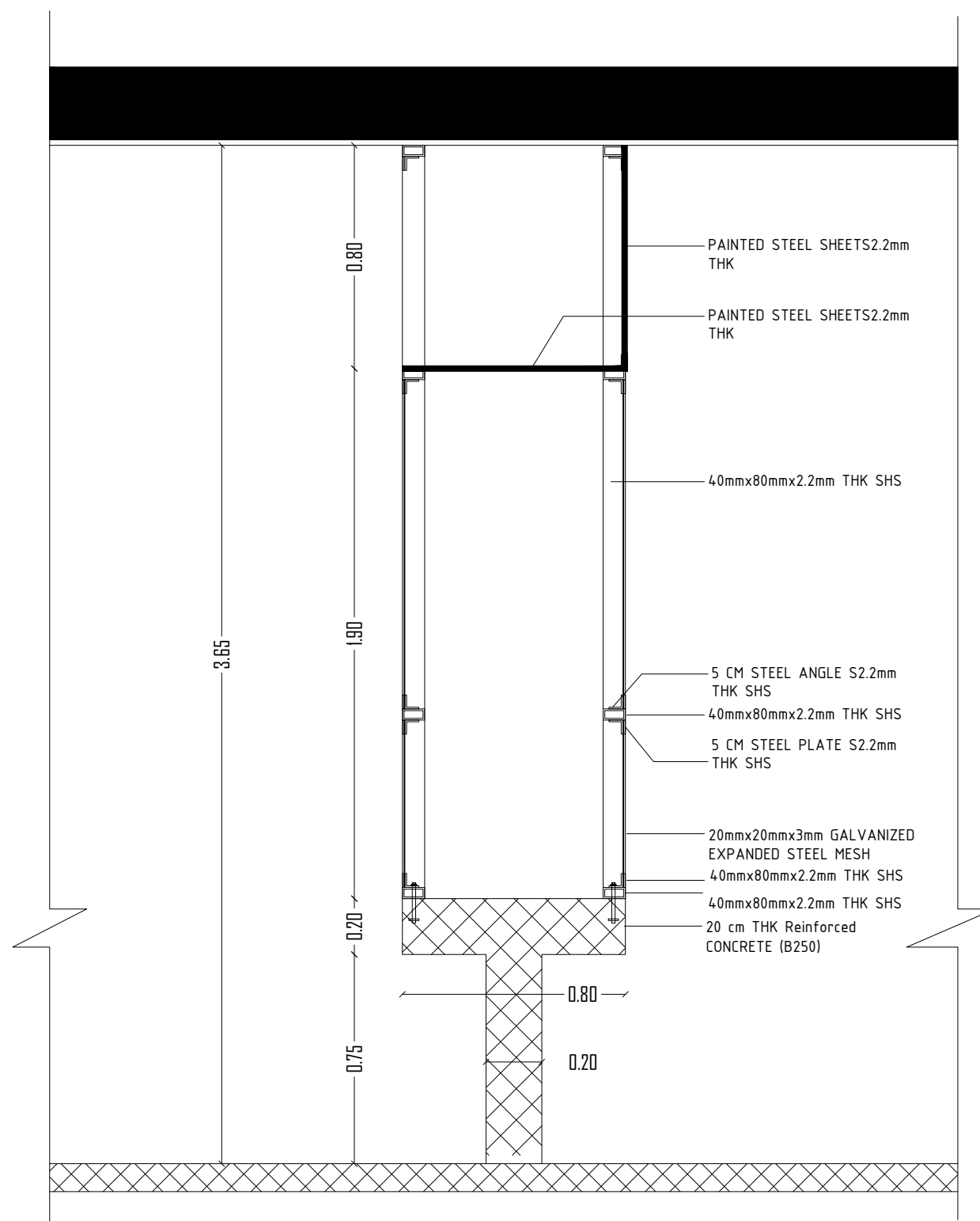

## NOTES

Rev.:	Date:	Description:	Approved:
-------	-------	--------------	-----------

All information in this document is the property of PALESTINIAN CIVIL POLICE and cannot be copied anywhere but in this project without prior written consent of PALESTINIAN CIVIL POLICE.

Partners:

The Independent Commission  
For Human Rights (ICHR)



PALESTINIAN CIVIL POLICE



Funded by:	
------------	--



Kingdom of Norway

Design & Implementation:
--------------------------



Q U R I E  
ARCHITECTURE

Project Name:
---------------

Detention Centers Rehabilitation  
Project in the West Bank  
(Norwegian Grant)

Title:

Book of Detail  
Police Requirement

Drawings Title:

### Visiting Room Partition Details

Project No.:		Phase:	Discipline:	Date:	Drawing No.:		
000000		01	Var	11.2021	11		
Drawn:	Checked:	Approved:	Size:	Scale:	Rev.:		
			A3	-			

# POLICE DETENTION CENTERS REHABILITATION PROJECT

Book of Detail - General

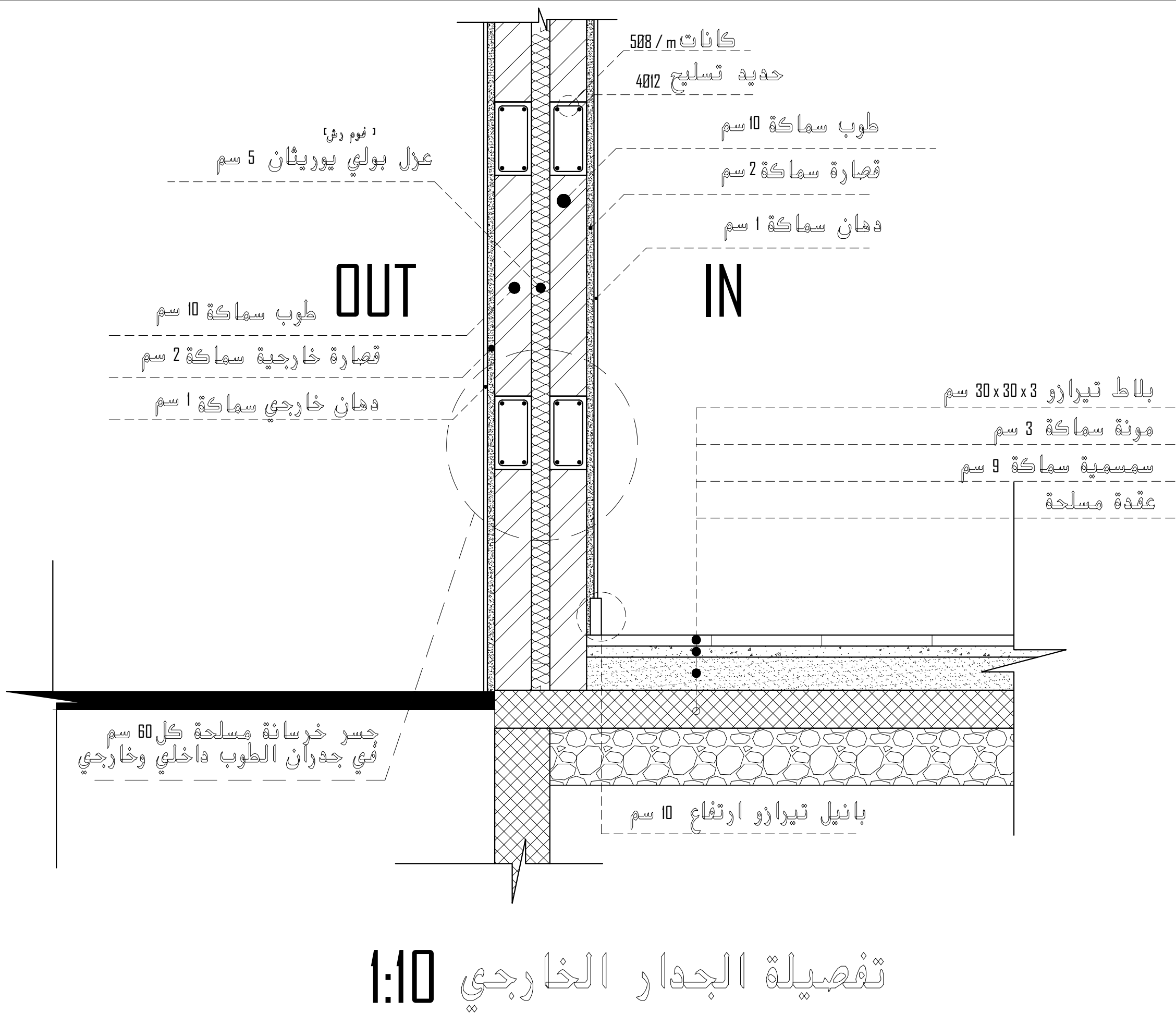

LEGEND

1- REINFORCED CONCRETE

2- CONCRETE BLOCK WALL

NOTES

Rev.:	Date:	Description:	Approved:
All information in this document is the property of PALESTINIAN CIVIL POLICE and cannot be copied anywhere but in this project without prior written consent of PALESTINIAN CIVIL POLICE.			

Partners:

The Independent Commission For Human Rights (ICHR)

PALESTINIAN CIVIL POLICE

Funded by:

Kingdom of Norway

Design & Implementation:

QURIE ARCHITECTURE

Project Name:

Detention Centers Rehabilitation Project in the West Bank (Norwegian Grant)

Title:

Book of Detail

Drawings Title:

Exterior Wall Detail for Al-Qalaa

Project No.:	Phase:	Discipline:	Date:	Drawing No.:
00000	01	Var	11.2021	1
Drawn:	Checked:	Approved:	Size:	Scale:
			A3	-

بلاط رخام بلدي مجلي قياس 60 X 60 X 3 cm

2 cm	مونة سماكة
4 cm	سمسية سماكة
20 cm	عقدة مسلحة سماكة
2 cm	قضارة سماكة

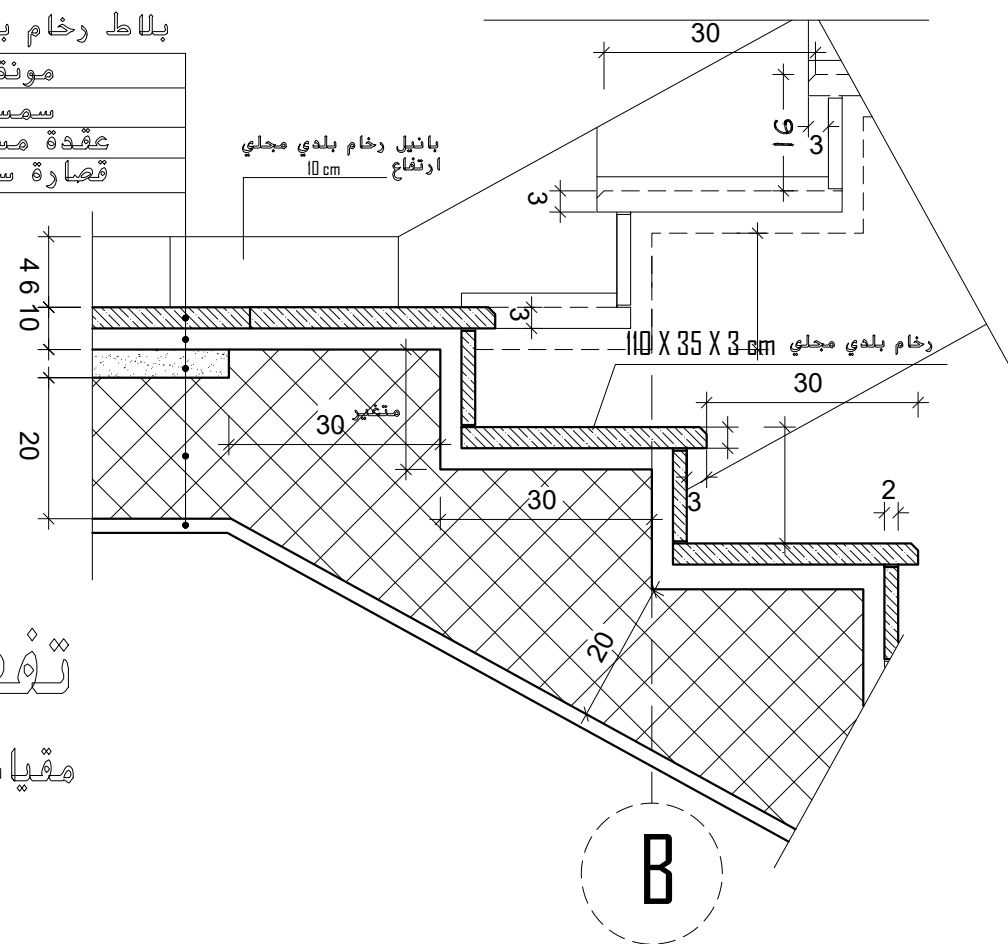

تفصيلة [١]

مقياس رسم 1:100

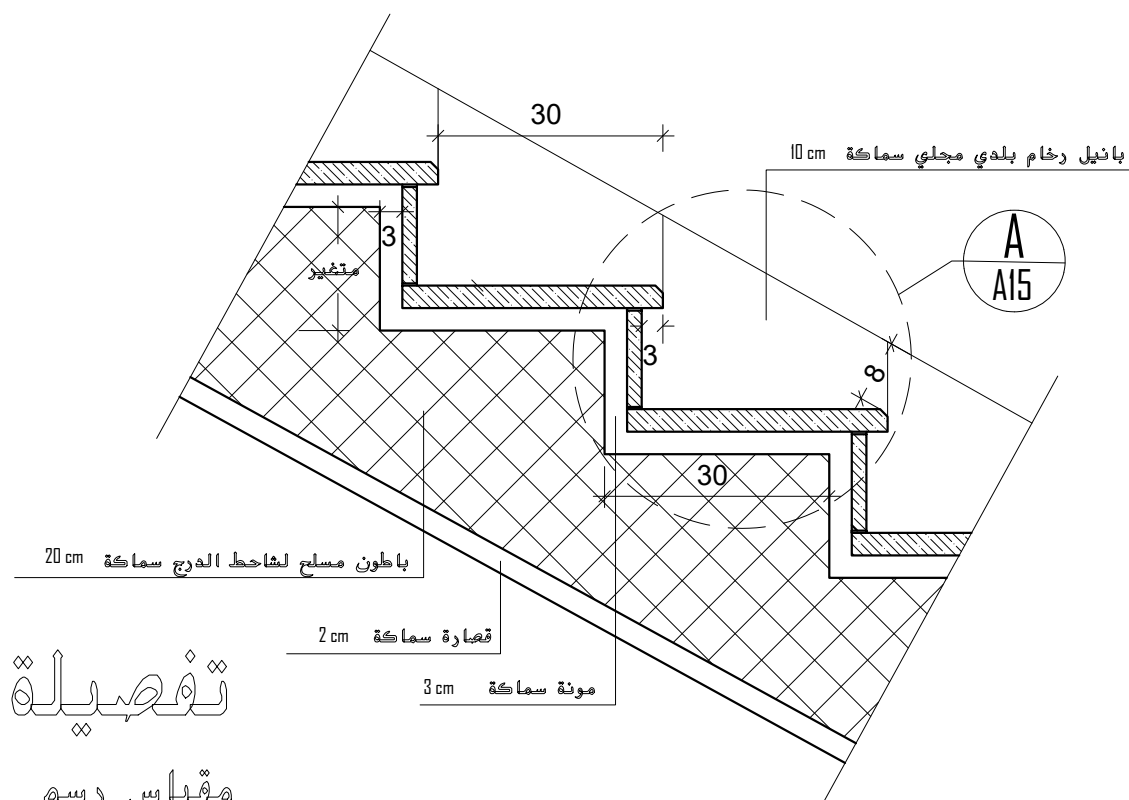

تفصيلة [٢]

مقياس رسم 1:100

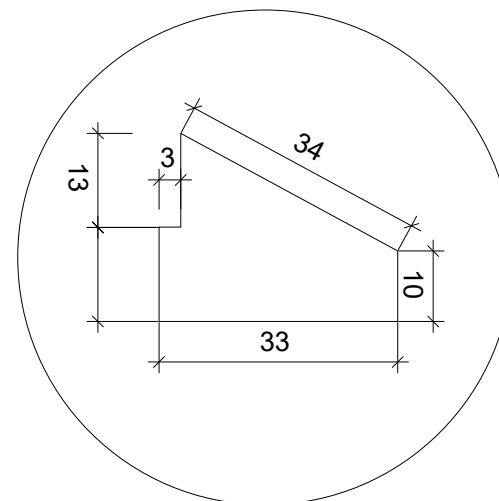

تفصيلة B

مقياس رسم 1:10

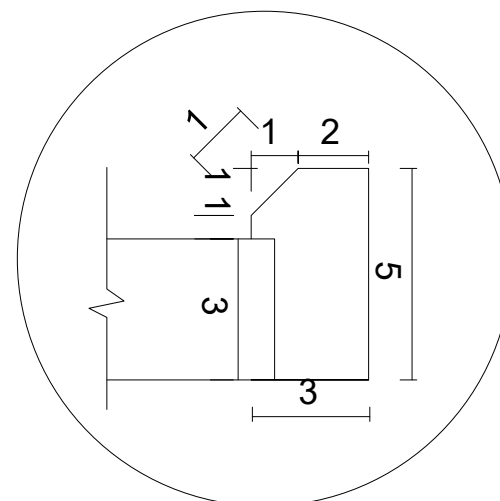

تفصيلة A

تفصيلة رداد ماء للدرجة

مقياس رسم 1:2

## LEGEND

1- REINFORCED CONCRETE



2- CONCRETE BLOCK WALL



## NOTES

Rev.: Date: Description: Approved:

All information in this document is the property of PALESTINIAN CIVIL POLICE and cannot be copied anywhere but in this project without prior written consent of PALESTINIAN CIVIL POLICE.

Partners:

The Independent Commission  
For Human Rights (ICHR)

PALESTINIAN CIVIL POLICE



Funded by:



Kingdom of Norway

Design & Implementation:



QURIE  
ARCHITECTURE

Project Name:

Detention Centers Rehabilitation  
Project in the West Bank  
(Norwegian Grant)

Title:

Book of Detail

Drawings Title:

Stairs Details

Project No.:	Phase:	Discipline:	Date:	Drawing No.:
000000	01	Var	11.2021	2
Drawn:	Checked:	Approved:	Size:	Scale:
			A3	-

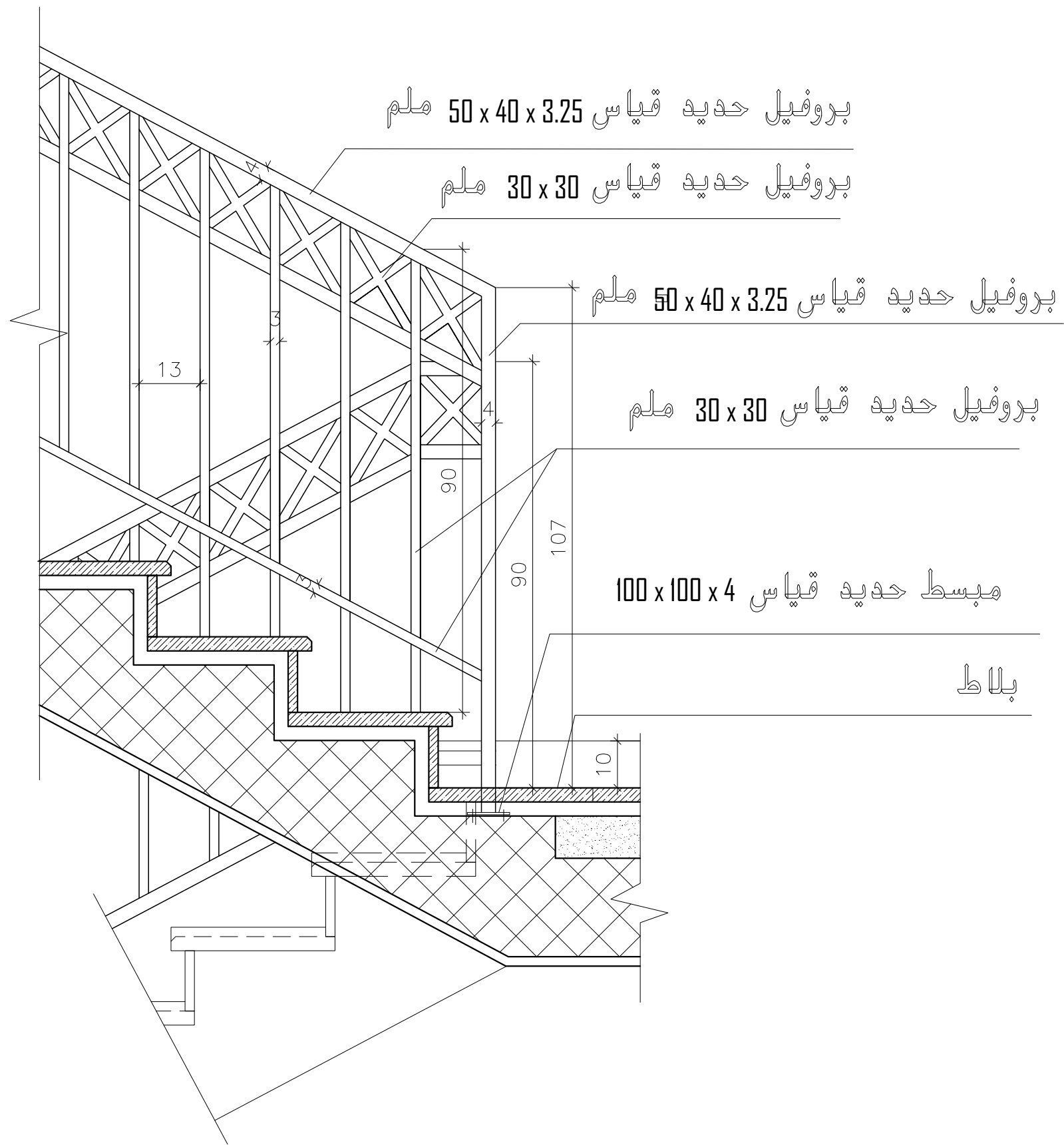

LEGEND

1- REINFORCED CONCRETE

2- CONCRETE BLOCK WALL





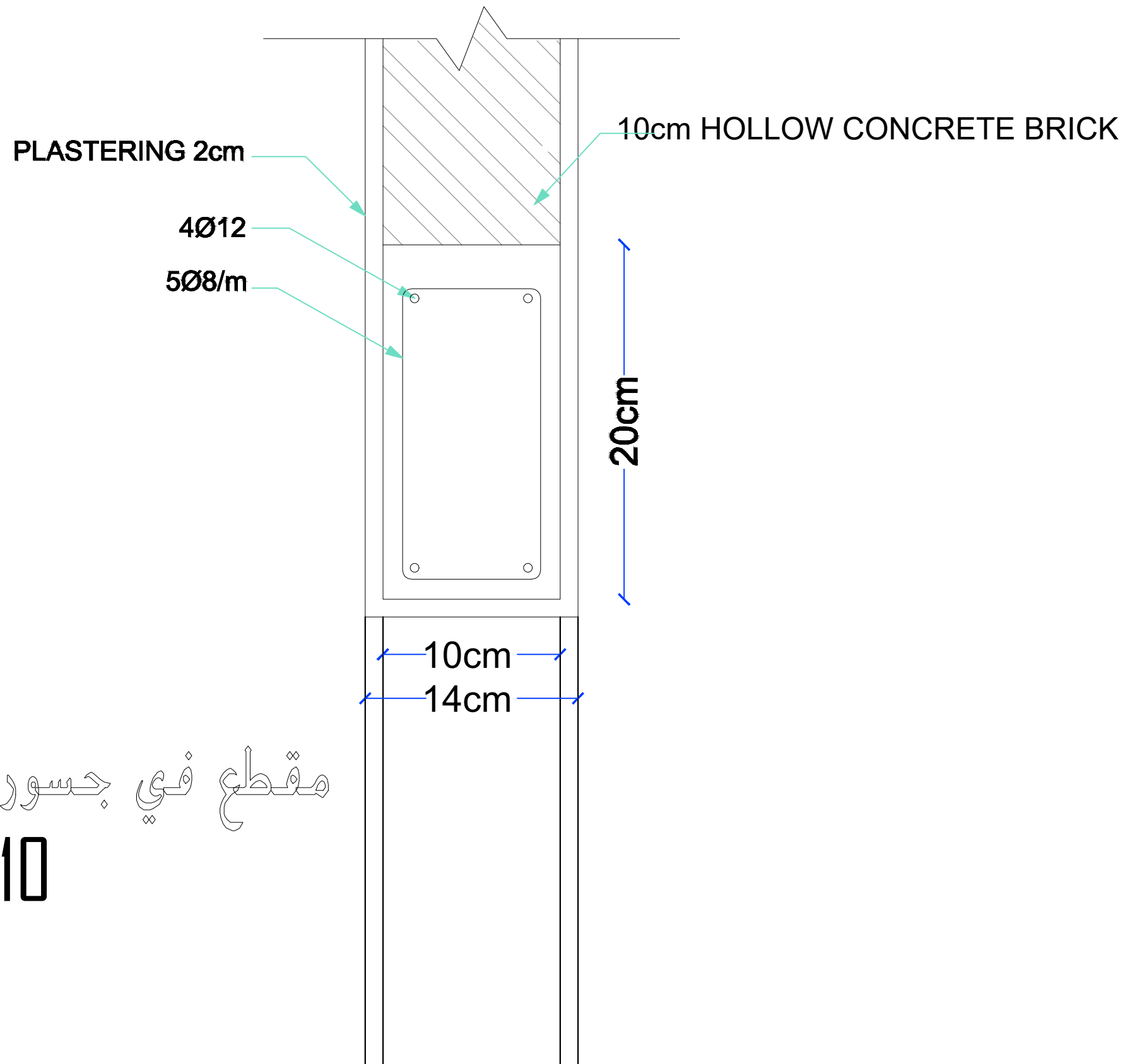

NOTES

Rev.:	Date:	Description:	Approved:	
All information in this document is the property of PALESTINIAN CIVIL POLICE and cannot be copied anywhere but in this project without prior written consent of PALESTINIAN CIVIL POLICE.				
Partners:				
The Independent Commission For Human Rights (ICHR)		PALESTINIAN CIVIL POLICE		
Funded by:				
		Kingdom of Norway		
Design & Implementation:				
		QURIE ARCHITECTURE		
Project Name:				
Detention Centers Rehabilitation Project in the West Bank (Norwegian Grant)				
Title:				
Book of Detail				
Drawings Title:				
Steel Railing Detail				
Project No.:	Phase:	Discipline:	Date:	Drawing No.:
00000	01	Var	11.2021	3
Drawn:	Checked:	Approved:	Size:	Scale:
			A3	-

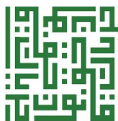

مقطع في جدران الطوب  
1:10



LEGEND					
1- REINFORCED CONCRETE					
2- CONCRETE BLOCK WALL					
NOTES					
Rev.:	Date:	Description:			Approved:
All information in this document is the property of PALESTINIAN CIVIL POLICE and cannot be copied anywhere but in this project without prior written consent of PALESTINIAN CIVIL POLICE.					
Partners:					
The Independent Commission For Human Rights (ICHR)			PALESTINIAN CIVIL POLICE		
					
Funded by:					
			Kingdom of Norway		
Design & Implementation:					
			QURIE ARCHITECTURE		
Project Name:					
Detention Centers Rehabilitation Project in the West Bank (Norwegian Grant)					
Title:					
Book of Detail					
Drawings Title:					
Typical Lintel Details					
Project No.:		Phase:	Discipline:	Date:	Drawing No.:
000000		01	Var	11.2021	4
Drawn:	Checked:	Approved:	Size:	Scale:	Rev.:
			A3	-	

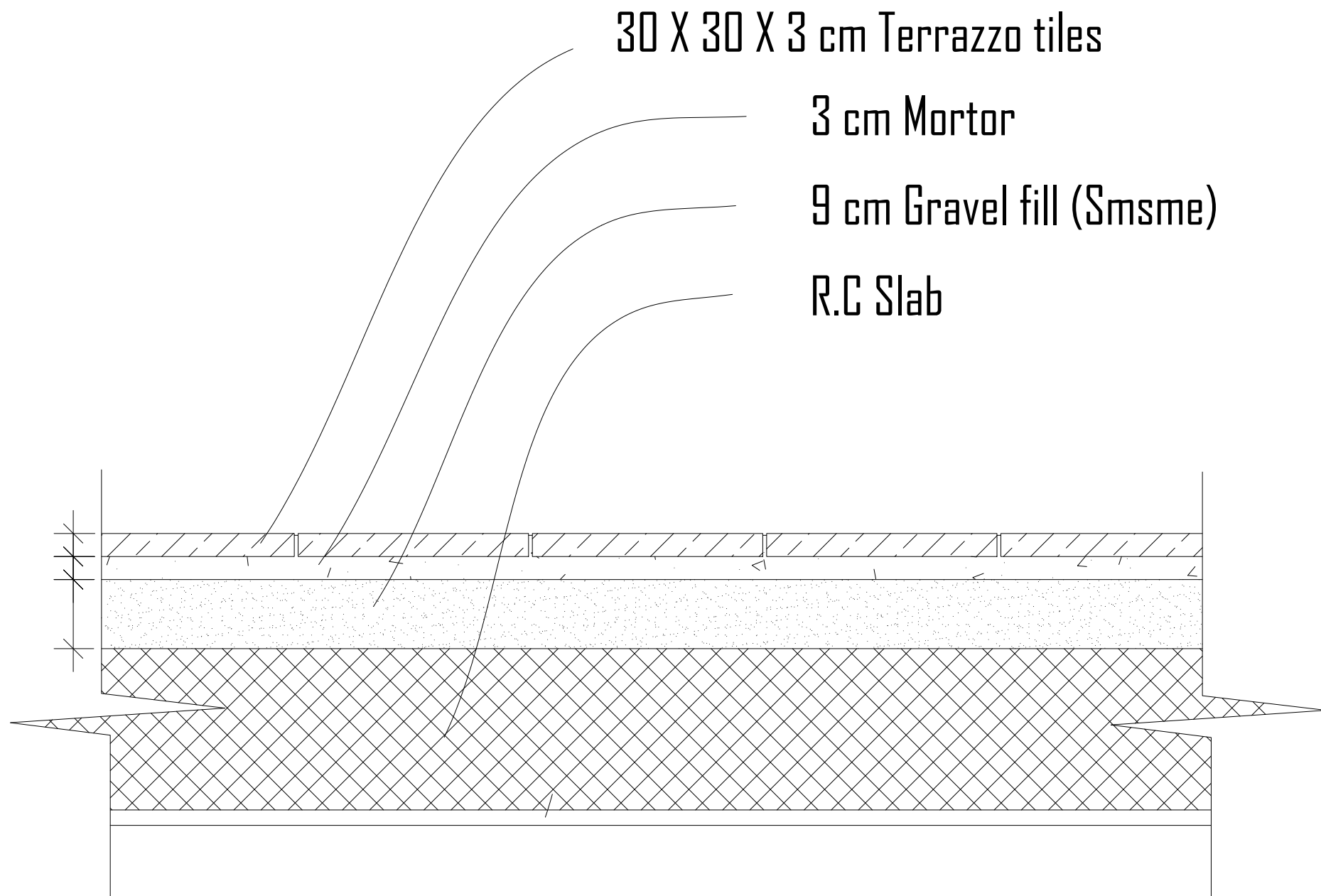

LEGEND

1- REINFORCED CONCRETE

2- CONCRETE BLOCK WALL

NOTES

Rev.:    Date:    Description:    Approved:

All information in this document is the property of PALESTINIAN CIVIL POLICE and cannot be copied anywhere but in this project without prior written consent of PALESTINIAN CIVIL POLICE.

Partners:

The Independent Commission For Human Rights (ICHR)

PALESTINIAN CIVIL POLICE

Funded by:

Kingdom of Norway

Design & Implementation:

QURIE ARCHITECTURE

Project Name:

Detention Centers Rehabilitation Project in the West Bank (Norwegian Grant)

Title:

Book of Detail

Drawings Title:

Tilling Detail

Project No.:	Phase:	Discipline:	Date:	Drawing No.:
00000	01	Var	11.2021	5
Drawn:	Checked:	Approved:	Size:	Scale:
			A3	-

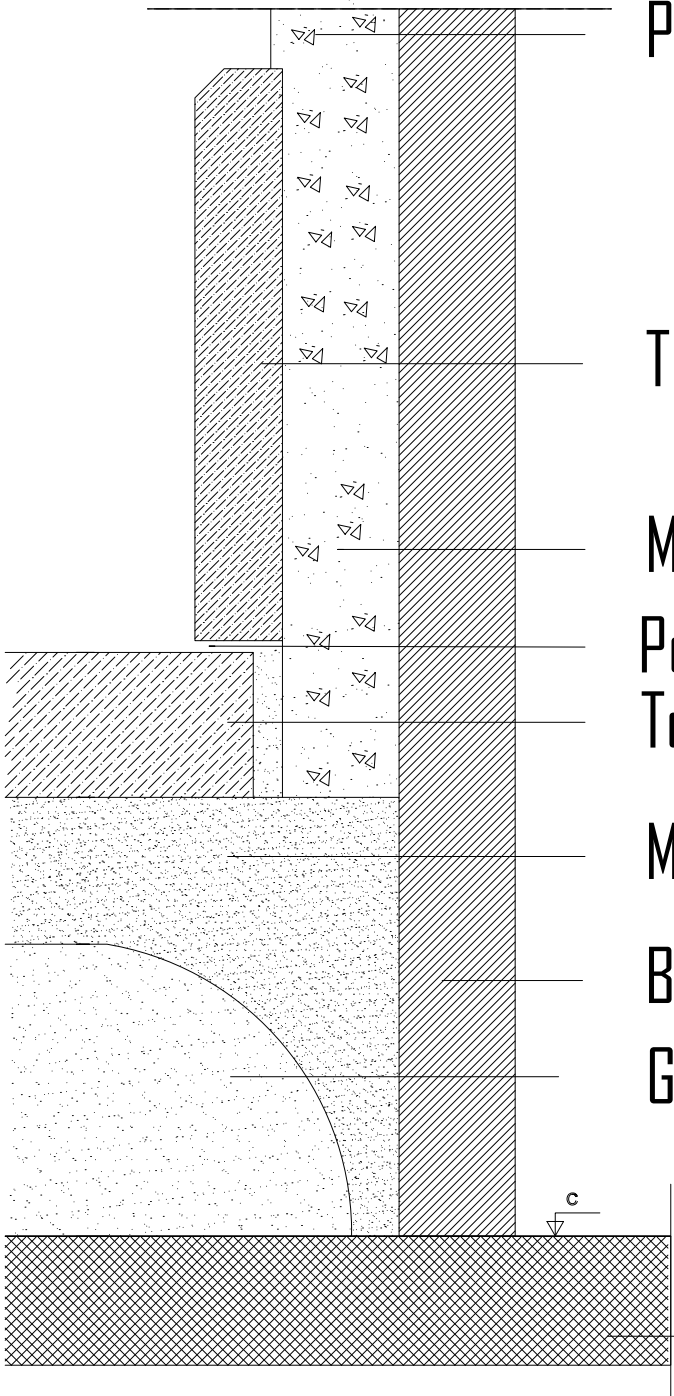

Plaster

Terrazzo Skirting 3cm

Mortar 2cm

Pointing with White Cement  
Terrazzo tiles 30 X 30 X 3 cm

Mortar 3cm

Block Wall

Gravel fill (Smsme) 9cm

LEGEND

1- REINFORCED CONCRETE



2- CONCRETE BLOCK WALL



NOTES



Rev.: Date: Description: Approved:

All information in this document is the property of PALESTINIAN CIVIL POLICE and cannot be copied anywhere but in this project without prior written consent of PALESTINIAN CIVIL POLICE.

Partners:

The Independent Commission  
For Human Rights (ICHR)

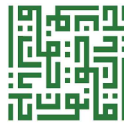
PALESTINIAN CIVIL POLICE



Funded by:



Kingdom of Norway

Design & Implementation:



QURIE  
ARCHITECTURE

Project Name:

Detention Centers Rehabilitation  
Project in the West Bank  
(Norwegian Grant)

Title:

Book of Detail

Drawings Title:

Skirting Detail

Project No.:	Phase:	Discipline:	Date:	Drawing No.:
00000	01	Var	11.2021	6
Drawn:	Checked:	Approved:	Size:	Scale:
			A3	-

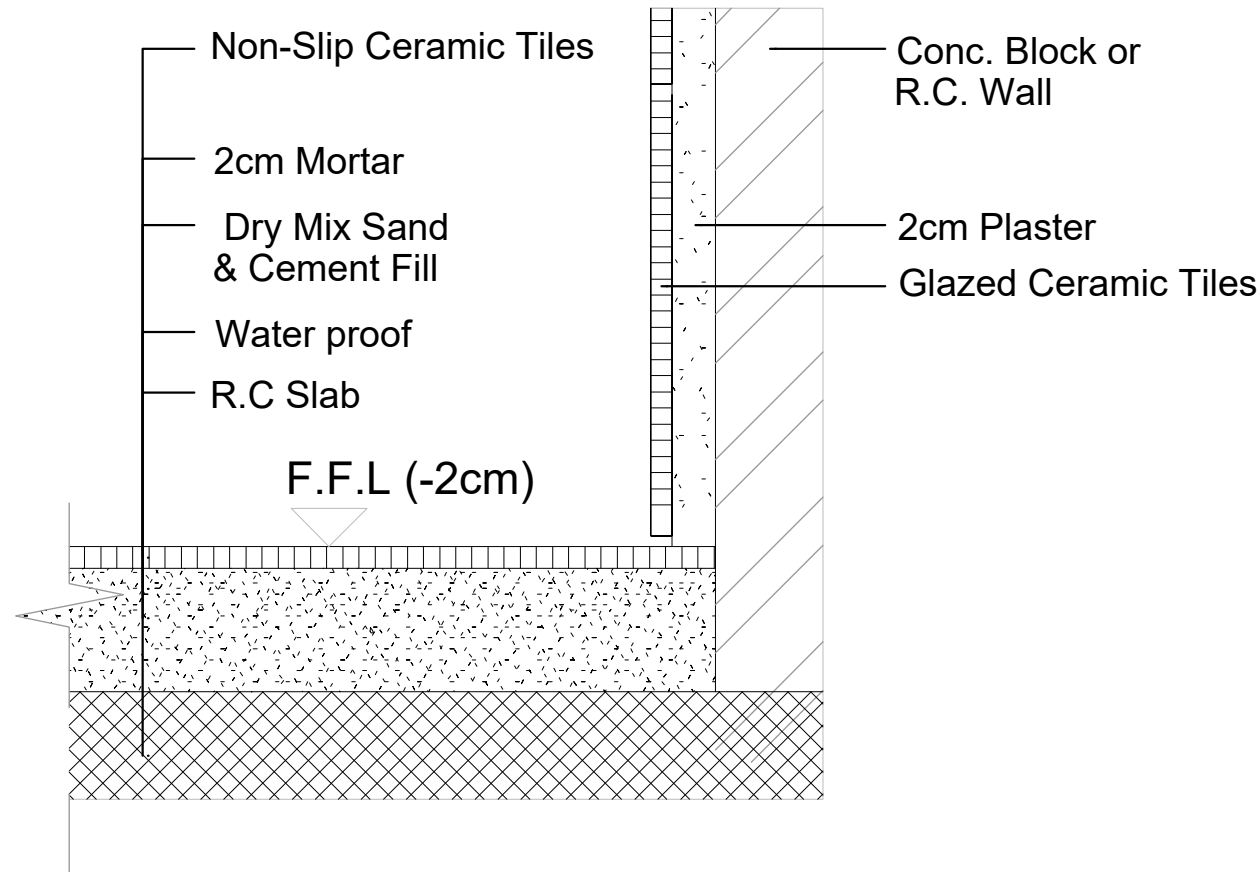

Ceramic Tiles Detail

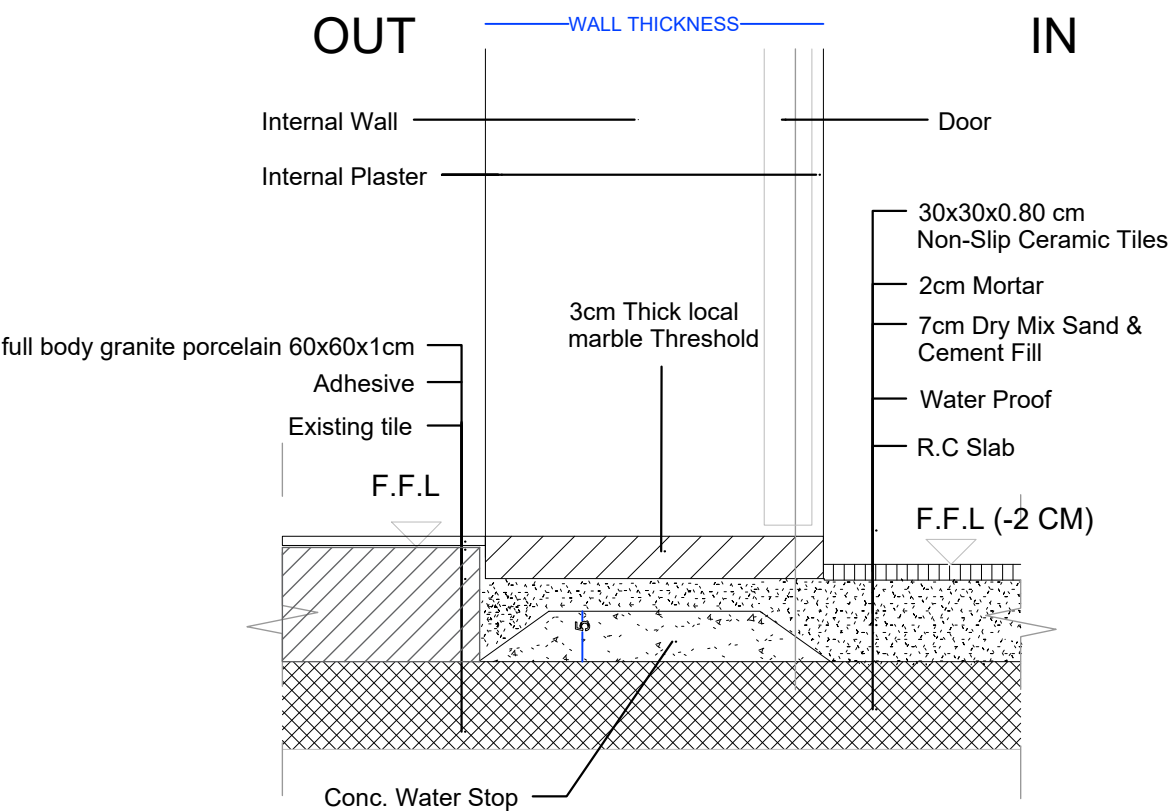

Toilet Door Threshold Detail

LEGEND

1- REINFORCED CONCRETE

2- CONCRETE BLOCK WALL

NOTES

Rev.:	Date:	Description:	Approved:

All information in this document is the property of PALESTINIAN CIVIL POLICE and cannot be copied anywhere but in this project without prior written consent of PALESTINIAN CIVIL POLICE.

Partners:

The Independent Commission For Human Rights (ICHR)

PALESTINIAN CIVIL POLICE

Funded by:

Kingdom of Norway

Design & Implementation:

QURIE ARCHITECTURE

Project Name:

Detention Centers Rehabilitation Project in the West Bank (Norwegian Grant)

Title:

Book of Detail

Drawings Title:

Shower Rooms and W'C Tilling Details

Project No.:	Phase:	Discipline:	Date:	Drawing No.:
00000	01	Var	11.2021	7
Drawn:	Checked:	Approved:	Size:	Scale:
			A3	-

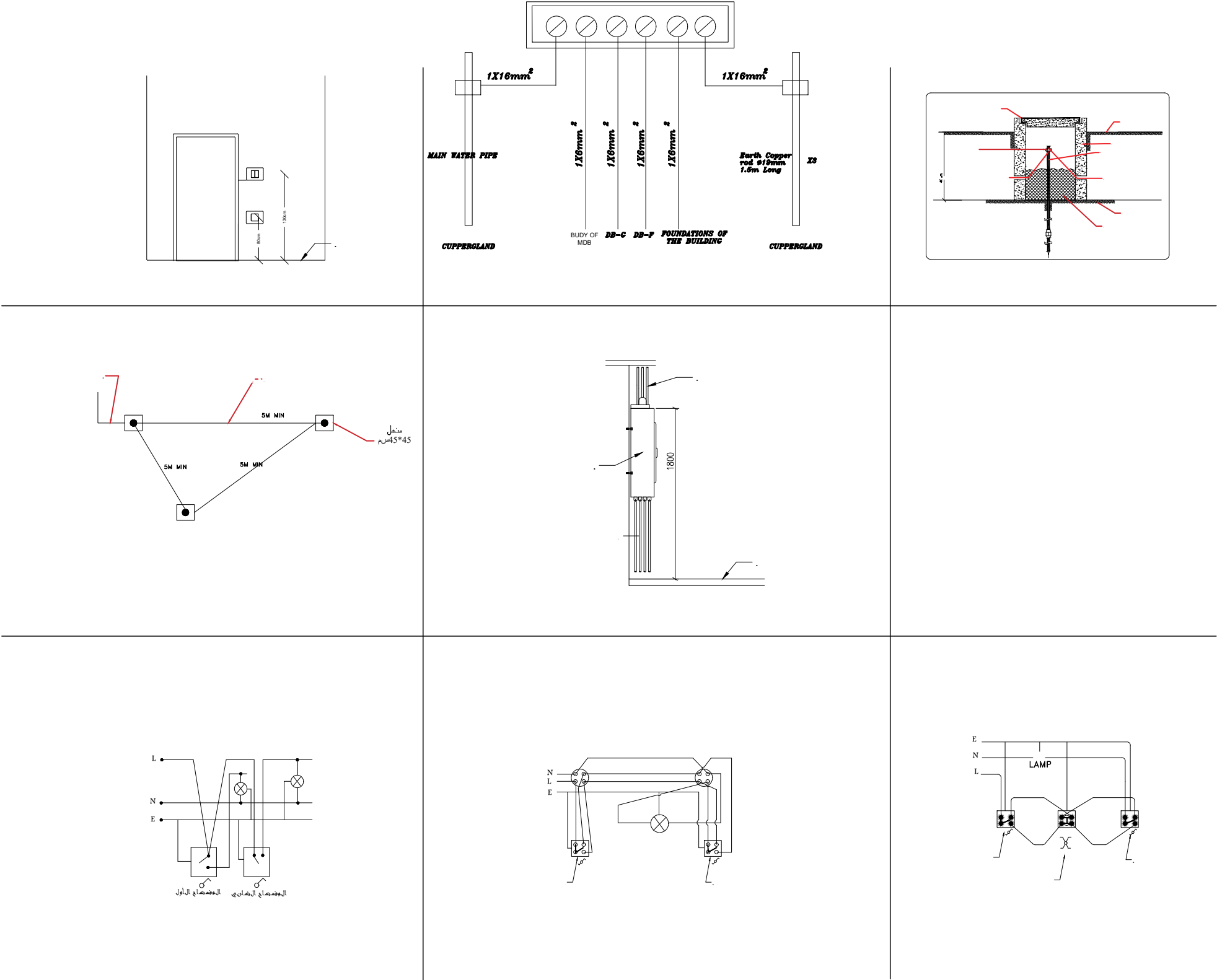

LEGEND

- 1- REINFORCED CONCRETE
- 2- CONCRETE BLOCK WALL

NOTES

Rev.: Date: Description: Approved:

All information in this document is the property of PALESTINIAN CIVIL POLICE and cannot be copied anywhere but in this project without prior written consent of PALESTINIAN CIVIL POLICE.

Partners:

The Independent Commission For Human Rights (ICHR)

PALESTINIAN CIVIL POLICE

Funded by:

Kingdom of Norway

Design & Implementation:

QURIE  
ARCHITECTURE

Project Name:

Detention Centers Rehabilitation Project in the West Bank (Norwegian Grant)

Title:

Book of Detail

Drawings Title:

Electrical Detail

Project No.:	Phase:	Discipline:	Date:	Drawing No.:
00000	01	Var	11.2021	8
Drawn:	Checked:	Approved:	Size:	Scale:
			A3	-

LEGEND

1- REINFORCED CONCRETE



2- CONCRETE BLOCK WALL



NOTES



Rev.:      Date:      Description:      Approved:

All information in this document is the property of PALESTINIAN CIVIL POLICE and cannot be copied anywhere but in this project without prior written consent of PALESTINIAN CIVIL POLICE.

Partners:

The Independent Commission  
For Human Rights (ICHR)

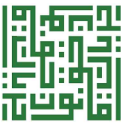
PALESTINIAN CIVIL POLICE



Funded by:



Kingdom of Norway

Design & Implementation:



QURIE  
ARCHITECTURE

Project Name:

Detention Centers Rehabilitation  
Project in the West Bank  
(Norwegian Grant)

Title:

Book of Detail

Drawings Title:

Mechanical Detail (1)

Project No.:	Phase:	Discipline:	Date:	Drawing No.:
00000	01	Var	11.2021	9
Drawn:	Checked:	Approved:	Size:	Scale:
			A3	-

Wash Basin Connections

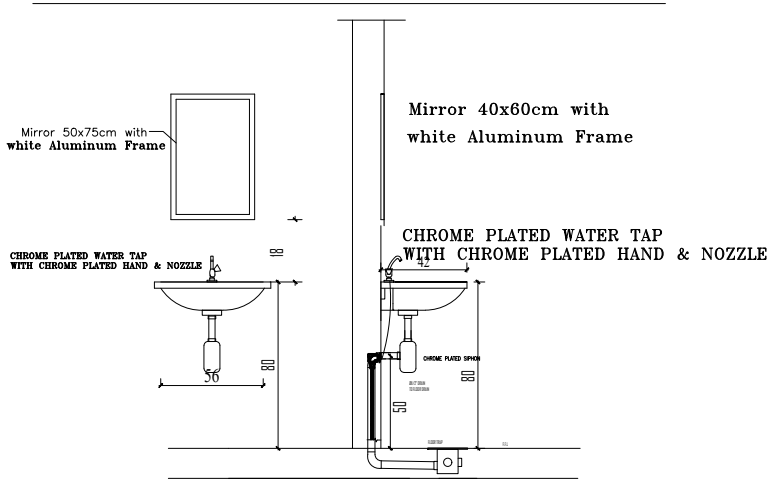

WALL HUNG EUROPEAN  
WATER CLOSET

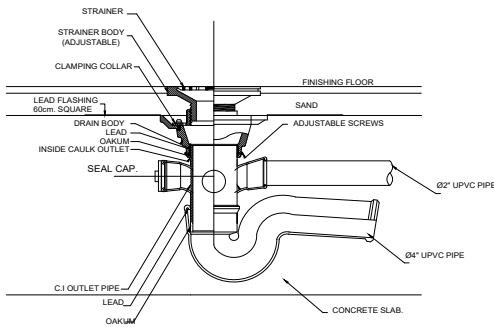
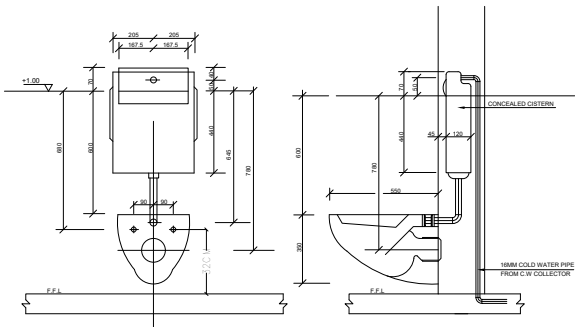

TYPICAL Ø4" FLOOR DRAIN DETAIL ( FD )

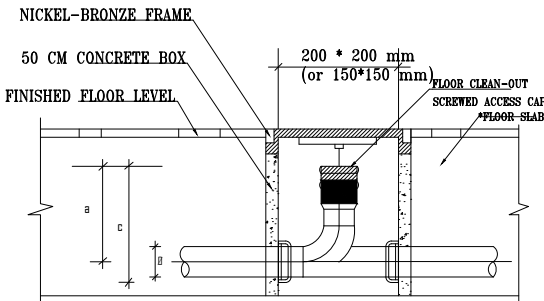

Ø	3" (82 mm)	4" (110 mm)	6" (160 mm)
c	205 mm	230 mm	250 mm
a	160 mm	180 mm	170 mm

UPVC FLOOR CLEAN-OUT DETAIL

\*SLAB CONSTRUCTION COULD BE ADDED FOR EACH APPLICATION INDIVIDUALLY

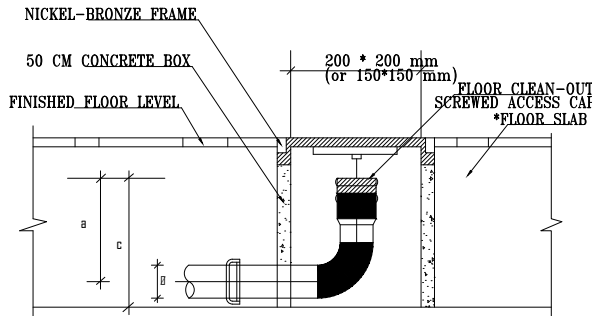

Ø	2" (50 mm)	3" (82 mm)	4" (110 mm)
c	134 mm	162 mm	192 mm
a	109 mm	121 mm	137 mm

\*SLAB CONSTRUCTION COULD BE ADDED FOR EACH APPLICATION INDIVIDUALLY

UPVC FLOOR CLEAN-OUT DETAIL  
(90 INCLINED)

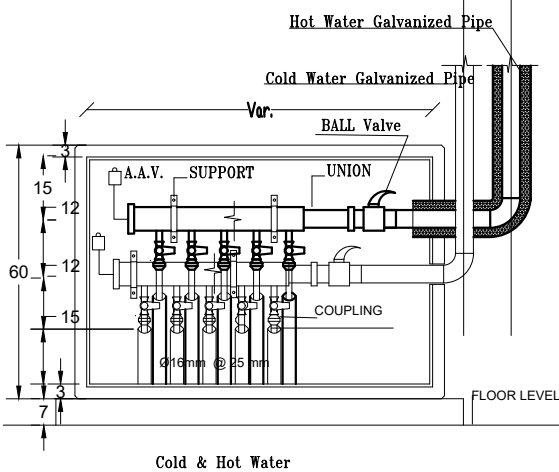
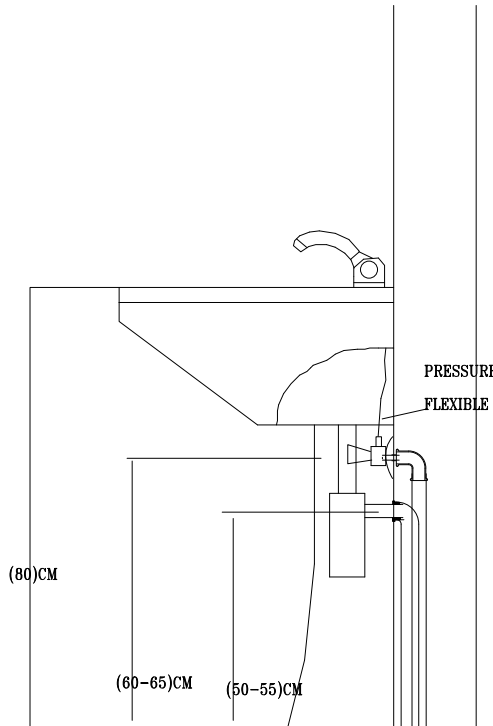

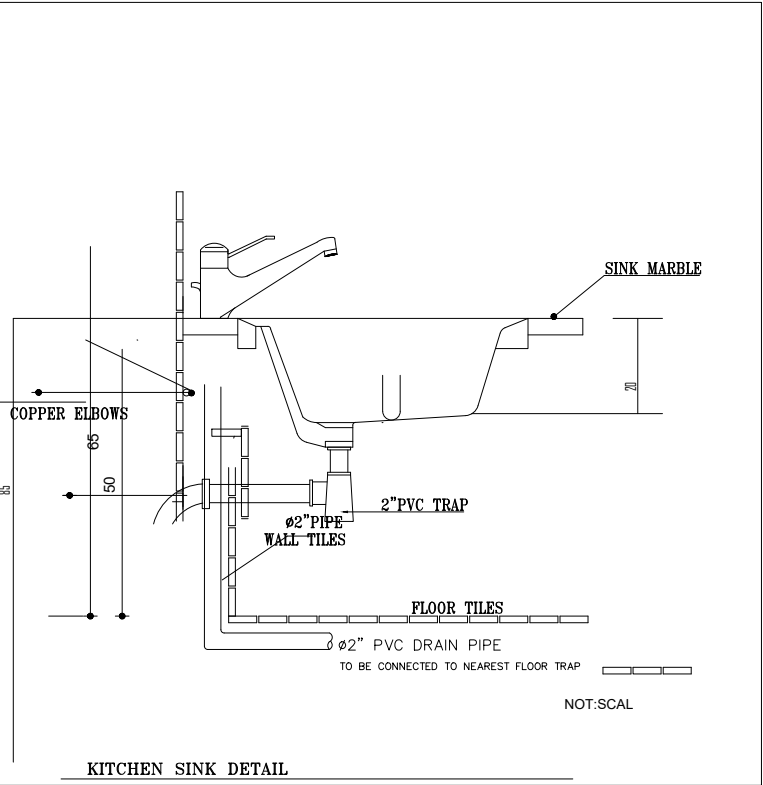
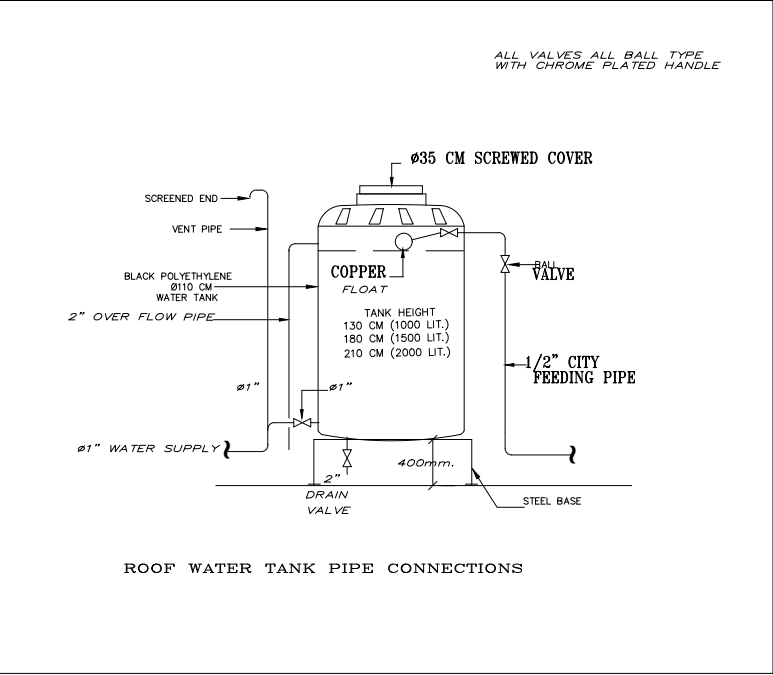
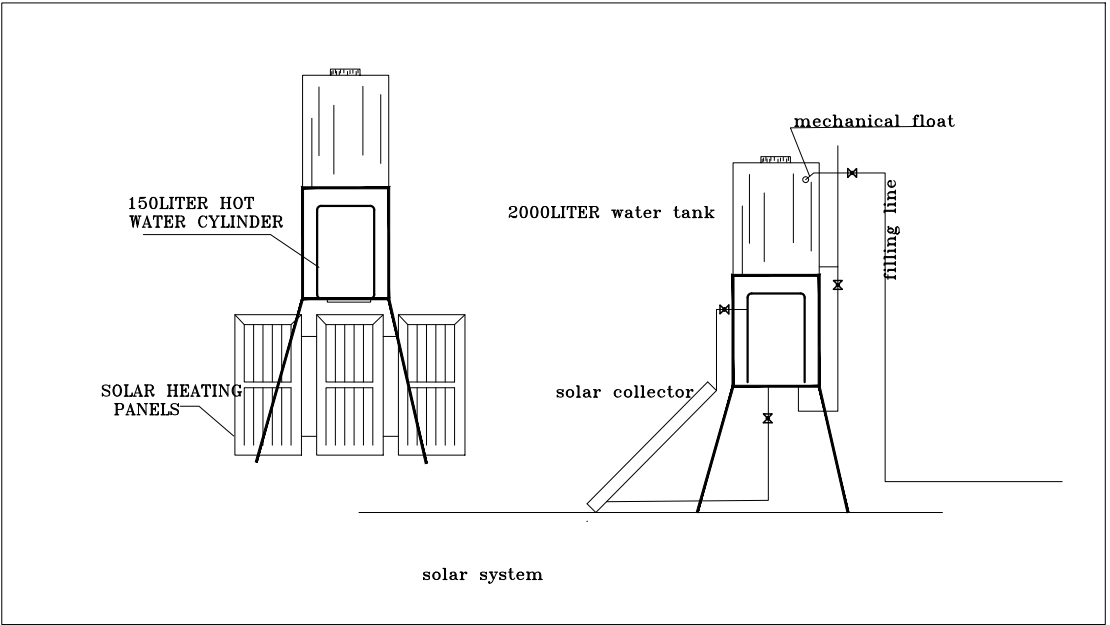
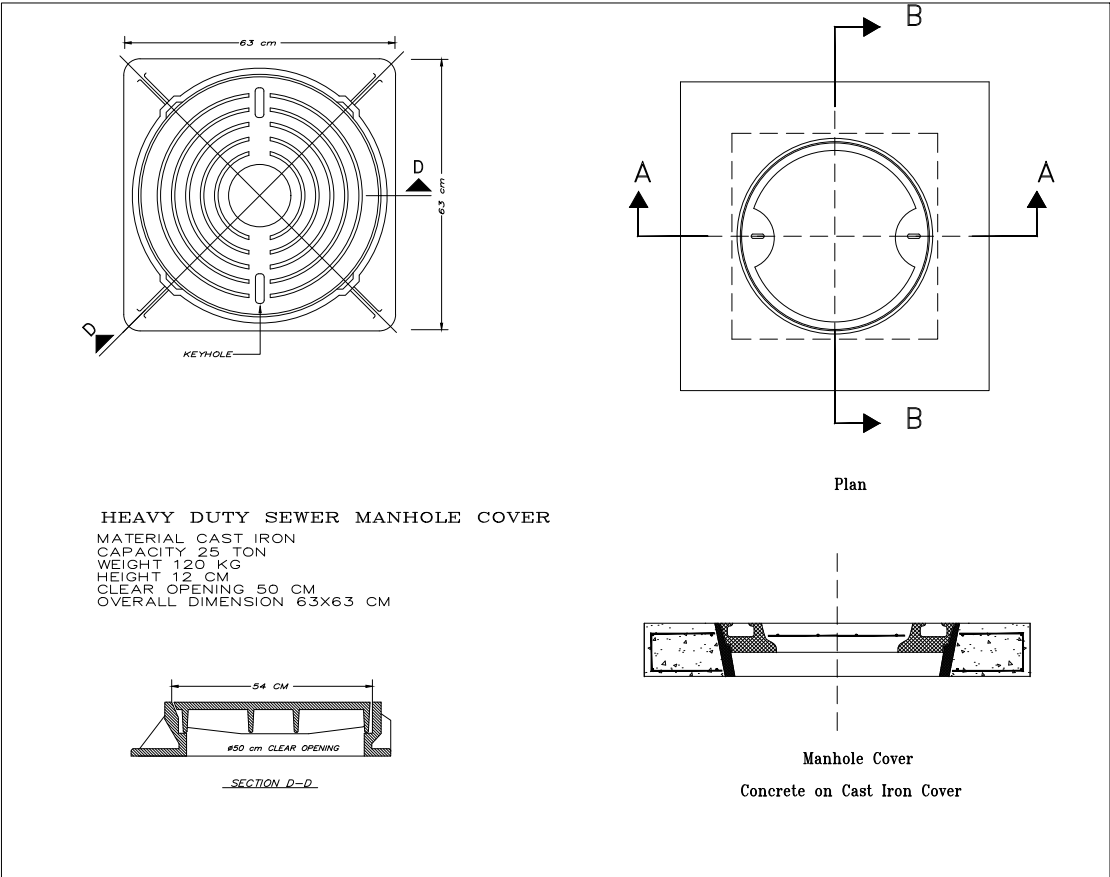

## LEGEND

1- REINFORCED CONCRETE



2- CONCRETE BLOCK WALL



## NOTES



Rev.:	Date:	Description:	Approved:
-------	-------	--------------	-----------

All information in this document is the property of PALESTINIAN CIVIL POLICE and cannot be copied anywhere but in this project without prior written consent of PALESTINIAN CIVIL POLICE.

Partners:

The Independent Commission  
For Human Rights (ICHR)

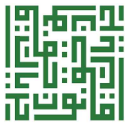
PALESTINIAN CIVIL POLICE



Funded by:



Kingdom of Norway

Design & Implementation:



QURIE  
ARCHITECTURE

Project Name:

Detention Centers Rehabilitation  
Project in the West Bank  
(Norwegian Grant)

Title:

Book of Detail

Drawings Title:

Mechanical Detail (2)

Project No.:	Phase:	Discipline:	Date:	Drawing No.:
00000	01	Var	11.2021	10
Drawn:	Checked:	Approved:	Size:	Scale:
			A3	-

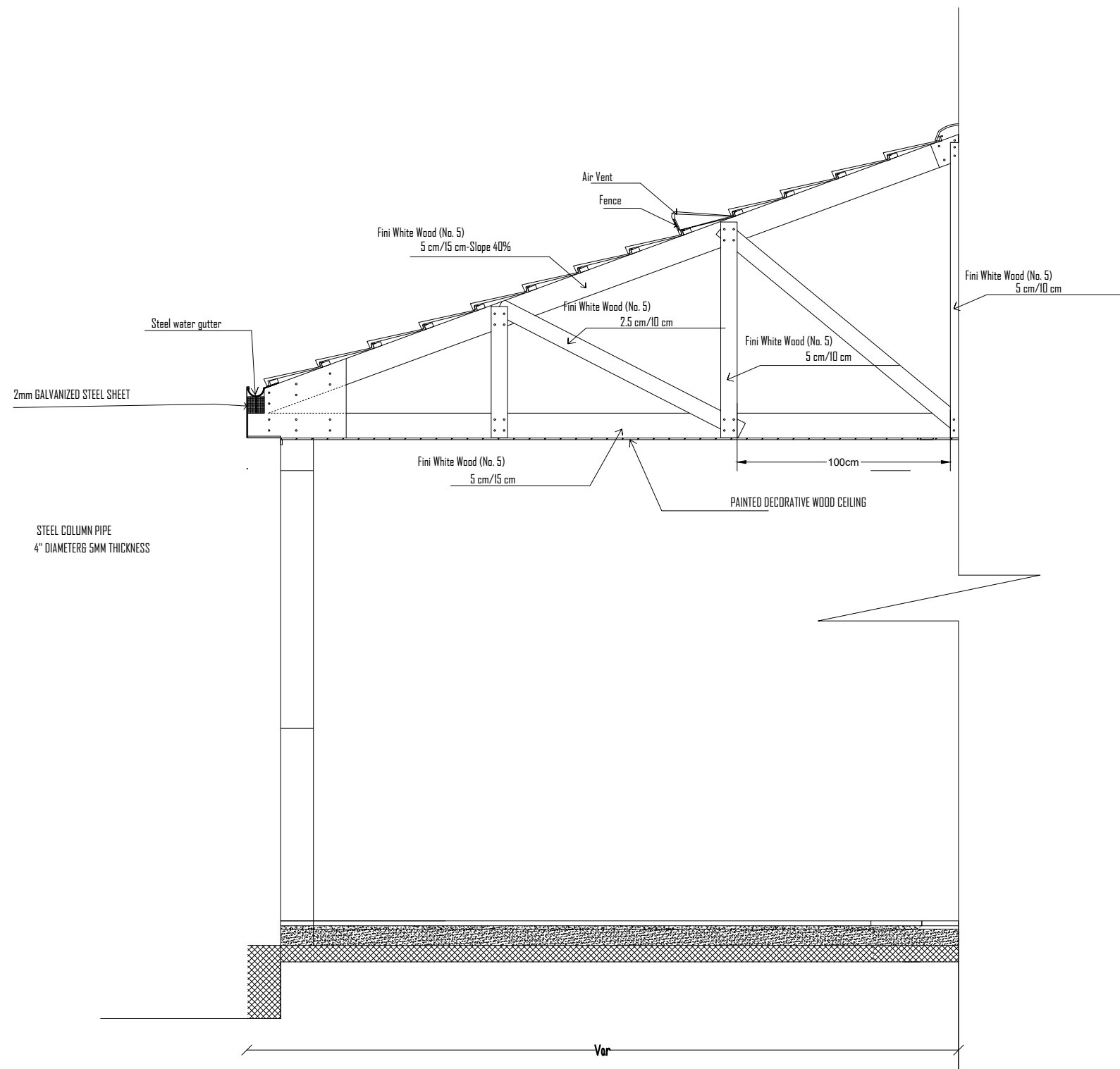





Typical Section In Qarmeed Roof

LEGEND

1- REINFORCED CONCRETE

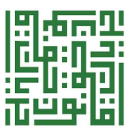
2- CONCRETE BLOCK WALL

NOTES

Rev.:	Date:	Description:	Approved:		
All information in this document is the property of PALESTINIAN CIVIL POLICE and cannot be copied anywhere but in this project without prior written consent of PALESTINIAN CIVIL POLICE.					
Partners:					
The Independent Commission For Human Rights (ICHR)		PALESTINIAN CIVIL POLICE			
					
Funded by:					
		Kingdom of Norway			
Design & Implementation:					
		QURIE ARCHITECTURE			
Project Name:					
Detention Centers Rehabilitation Project in the West Bank (Norwegian Grant)					
Title:					
Book of Detail					
Drawings Title:					
Qarmeed Roof					
Project No.:	Phase:	Discipline:	Date:	Drawing No.:	
00000	01	Var	11.2021	10	
Drawn:	Checked:	Approved:	Size:	Scale:	Rev.:
			A3	-	